



**SENATE BILL 844, ADULT LOCAL  
CRIMINAL JUSTICE FACILITIES  
CONSTRUCTION FINANCING PROGRAM  
PROPOSAL FORM**

*This document is not to be reformatted.*

**SECTION 1: PROJECT INFORMATION**

<b>A. APPLICANT INFORMATION AND PROPOSAL TYPE</b>			
COUNTY NAME PLACER COUNTY SHERIFF'S OFFICE		STATE FINANCING REQUESTED \$ 30 MILLION	
SMALL COUNTY (Below 200,000 GENERAL COUNTY POPULATION) <input type="checkbox"/>	MEDIUM COUNTY (200,000 - 700,000 GENERAL COUNTY POPULATION) <input checked="" type="checkbox"/>	LARGE COUNTY (700,001 + GENERAL COUNTY POPULATION) <input type="checkbox"/>	
TYPE OF PROPOSAL – INDIVIDUAL COUNTY FACILITY /REGIONAL FACILITY PLEASE CHECK ONE (ONLY):			
INDIVIDUAL COUNTY FACILITY <input checked="" type="checkbox"/>		REGIONAL FACILITY <input type="checkbox"/>	
<b>B: BRIEF PROJECT DESCRIPTION</b>			
FACILITY NAME SOUTH PLACER COUNTY JAIL – SPIRIT FACILITY – (SOUTH PLACER INMATE REHABILITATION AND INSTRUCTIONAL TRAINING)			
PROJECT DESCRIPTION Projects consists of 6 areas of construction: <ol style="list-style-type: none"> <li>1) 60 bed Re-Entry Men's Housing Unit, in-person visitation, recreation area</li> <li>2) 60 bed Female Minimum Housing unit, in-person visitation, recreation area</li> <li>3) New Educational, Life Skills and Behavioral training classroom facilities</li> <li>4) Vocational Shop facility</li> <li>5) Food services and laundry equipment</li> <li>6) Site infrastructure upgrades; site work, fencing, utilities and parking</li> </ol>			
STREET ADDRESS 11801 Go For Broke Road			
CITY Roseville	STATE CA	ZIP CODE 95678	
<b>C. SCOPE OF WORK – INDICATE FACILITY TYPE AND CHECK ALL BOXES THAT APPLY.</b>			
FACILITY TYPE (II, III or IV) II,IV	<input type="checkbox"/> NEW STAND-ALONE FACILITY	<input type="checkbox"/> RENOVATION/ REMODELING	<input checked="" type="checkbox"/> CONSTRUCTING BEDS OR OTHER SPACE AT EXISTING FACILITY
<b>D. BEDS CONSTRUCTED – Provide the number of BSCC-rated beds and non-rated special use beds that will be subject to construction as a result of the project, <u>whether remodel/renovation or new construction.</u></b>			
A. MINIMUM SECURITY BEDS	B. MEDIUM SECURITY BEDS	C. MAXIMUM SECURITY BEDS	D. SPECIAL USE BEDS

Number of beds constructed, remodeled	60	60	0	0
TOTAL BEDS (A+B+C+D)	120 Beds at the South Placer Jail	E. BEDS REMOVED/ DECOMMISSIONED		F. NET BEDS AFTER COMPLETED PROJECT
		120 Beds Decommissioned in Housing Unit 3 at the Auburn Jail		Net Gain 0 Beds

**E. APPLICANT'S AGREEMENT**

By signing this application, the authorized person assures that: a) the County will abide by the laws, regulations, policies, and procedures governing this financing program; and, b) certifies that the information contained in this proposal form, budget, narrative, and attachments is true and correct to the best of his/her knowledge.

**PERSON AUTHORIZED TO SIGN AGREEMENT**

NAME Jennifer Montgomery TITLE Chair, Board Of Supervisors

AUTHORIZED PERSON'S SIGNATURE

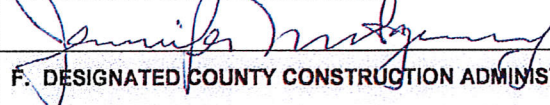

DATE

2/21/17

**F. DESIGNATED COUNTY CONSTRUCTION ADMINISTRATOR**

This person shall be responsible to oversee construction and administer the state/county agreements. (Must be county staff, not a consultant or contractor, and must be identified in the Board of Supervisors' resolution.)

**COUNTY CONSTRUCTION ADMINISTRATOR**

NAME Lisa James TITLE Capital Facilities Manager

DEPARTMENT

Public Works and Facilities

TELEPHONE NUMBER

530 886-4948

STREET ADDRESS

11476 C Avenue

CITY

Auburn

STATE

CA

ZIP CODE

95603

E-MAIL ADDRESS

LJames@placer.ca.gov

**G. DESIGNATED PROJECT FINANCIAL OFFICER**

This person is responsible for all financial and accounting project related activities. (Must be county staff, not a consultant or contractor, and must be identified in the Board of Supervisors' resolution.)

**PROJECT FINANCIAL OFFICER**

NAME Valerie Bayne TITLE Administrative Services Manager

DEPARTMENT

Placer Facility Services

TELEPHONE NUMBER

530 889-6809

STREET ADDRESS

11476 C Avenue

CITY

Auburn

STATE

CA

ZIP CODE

95603

E-MAIL ADDRESS

VBayne@placer.ca.gov

**H. DESIGNATED PROJECT CONTACT PERSON**

This person is responsible for project coordination and day-to-day liaison work with the BSCC. (Must be county staff, not a consultant or contractor, and must be identified in the Board of Supervisors' resolution.)

**PROJECT CONTACT PERSON**

NAME Carol Walsh TITLE Lieutenant

DEPARTMENT Placer County Sheriff's Office		TELEPHONE NUMBER 916 408-6333	
STREET ADDRESS 10820 Justice Center Drive			
CITY Roseville	STATE CA	ZIP CODE 95678	E-MAIL ADDRESS CWalsh@placer.ca.gov

## SECTION 2: BUDGET SUMMARY

### Budget Summary Instructions

**(This must be part of the 35page narrative)** Definitions of total project costs for purposes of this program (state reimbursed, county cash contribution, and county in-kind contribution) can be found in the “Budget Considerations” page 22 of the Senate Bill (SB) 844, Construction of Adult Local Criminal Justice Facilities (ALCJF’s) Request for Proposals (RFP). The county cash and in-kind contributions are collectively the county contribution. Those defined costs in the RFP shall be the guide for accurately completing this budget summary section.

In the Budget Summary Table that follows in part D of this section, indicate the amount of state financing requested and the amount of cash and/or in-kind contributions allotted to each budget line-item, in total defining the total project costs. It is necessary to fully include each eligible project cost for state-reimbursed, county cash, and county in-kind contribution amounts.

The in-kind contribution line items represent only county staff salaries and benefits, needs assessment costs, transition planning costs and/or current fair market value of land. An appraisal of land value will only be required after conditional award and only if land value is included as part of the county’s contribution.

The total amount of state financing requested cannot exceed 90 percent of the total project costs. The county contribution must be a minimum of 10 percent of the total project costs (unless the applicant is a small county petitioning for a reduction in the county contribution amount). County contributions can be any combination of cash or in-kind project costs. Small counties requesting a reduction in county contribution must state so in part A of this section. The County contribution must include all costs directly related to the project necessary to complete the design and construction of the proposed project, except for those eligible costs for which state reimbursement is being requested.

State financing limits (maximums) for all county proposals are as follows. For proposed regional ALCJF’s, the size of the lead county determines the maximum amount of funds to be requested for the entire project. In the small county category the lead county may request up to an additional 10% of the maximum amount as an incentive to build a regional facility:

- **\$70,000,000** for large counties;
- **\$30,000,000** for medium counties; and,
- **\$25,000,000** for small counties.

**A. Under 200,000 Population County Petition for Reduction in Contribution**

Counties with a population below 200,000 may petition the Board of State and Community Corrections (BSCC) for a reduction in its county contribution. This proposal document will serve as the petition and the BSCC Board's acceptance of the county's contribution reduction, provided the county abides by all terms and conditions of this SB 844 RFP and Proposal process and receives a conditional award. The county (below 200,000 population) may request to reduce the required match to an amount not less than the total non-state reimbursable projects cost as defined in Title 15, Division 1, Chapter 1, Subchapter 6, Construction Financing Program section 1712.3. If requesting a reduction in match contribution, check the box below to indicate the county's petition.

**By checking this box the county hereby petitions for a contribution reduction request as reflected in the proposal budget.**

**B. Readiness to Proceed Preference**

In order to attest that the county is seeking the readiness to proceed with the proposed project, the county included a Board of Supervisors' resolution doing the following: 1) identifying and authorizing an adequate amount of available matching funds to satisfy the counties' contribution, 2) approving the forms of the project documents deemed necessary, as identified by the board to the BSCC, to effectuate the financing authorized in SB 844 3) and authorizing the appropriate signatory or signatories to execute those documents at the appropriate times. The identified matching funds in the resolution shall be compatible with the state's lease revenue bond financing. Additionally see Section 6 "Board of Supervisors' Resolution" for further instructions.

**This proposal includes a Board of Supervisors' Resolution that is attached and includes language that assures funding is available and compatible with state's lease revenue bond financing. See below for the description of compatible funds.**

*County Cash Contribution Funds Are Legal and Authorized.* The payment of the county cash contribution funds for the proposed adult local criminal justice facility project (i) is within the power, legal right, and authority of the County; (ii) is legal and will not conflict with or constitute on the part of the County a material violation of, a material breach of, a material default under, or result in the creation or imposition of any lien, charge, restriction, or encumbrance upon any property of the County under the provisions of any charter instrument, bylaw, indenture, mortgage, deed of trust, pledge, note, lease, loan, installment sale agreement, contract, or other material agreement or instrument to which the County is a party or by which the County or its properties or funds are otherwise subject or bound, decree, or demand of any court or governmental agency or body having jurisdiction over the County or any of its activities, properties or funds; and (iii) have been duly authorized by all necessary and appropriate action on the part of the governing body of the County.

*No Prior Pledge.* The county cash contribution funds and the Project are not and will not be mortgaged, pledged, or hypothecated by the County in any manner or for any purpose and have not been and will not be the subject of a grant of a security interest by the County. In addition, the county cash contribution funds and the

Project are not and will not be mortgaged, pledged, or hypothecated for the benefit of the County or its creditors in any manner or for any purpose and have not been and will not be the subject of a grant of a security interest in favor of the County or its creditors. The County shall not in any manner impair, impede or challenge the security, rights and benefits of the owners of any lease-revenue bonds sold by the State Public Works Board for the Project (the "Bonds") or the trustee for the Bonds.

*Authorization to Proceed with the Project.* The Project proposed in the County's SB 844 Financing Program proposal is authorized to proceed in its entirety when and if state financing is awarded for the Project within the SB 844 Financing Program.

**C. California Environmental Quality Act (CEQA) compliance**

Has the county completed the CEQA compliance for the project site?

**Yes. If so, include documentation evidencing the completion (preference points).**

**No. If no, describe the status of the CEQA certification.**

**D. Agreement Not to Lease Beds if Increasing County Capacity**

If the proposed project results in a net increase in rated beds in the county, will the county certify and covenant in writing that the county will not lease housing capacity from the proposed SB 844 project to any other public or private entities for a period of 10 years beyond the completion date of the adult local criminal justice facility?

**Yes. The County agrees that if the project results in a net increase in rated beds, the County will not lease capacity in the SB 844 financed adult local criminal justice facility to any other public or private entity for a period of 10 years beyond the completion date of the adult local criminal justice facility. The County further agrees to certify and covenant in writing to this requirement in future agreements as provided by the BSCC and/or SPWB.**

**No. (Project not eligible for SB844 funding)**

**E. Budget Summary Table (Report to Nearest \$1,000)**

LINE ITEM	STATE REIMBURSED	CASH CONTRIBUTION	IN-KIND CONTRIBUTION	TOTAL
1. Construction	\$ 26,394,333	\$		\$ 26,394,333
2. Additional Eligible Costs*	\$ 1,600,000	\$ 170,000		\$ 1,770,000
3. Architectural	\$ 1,300,000	\$ 1,300,000		\$ 2,600,000
4. Project/Construction Management	\$ 705,667	\$ 741,333		\$ 1,447,000
5. CEQA	\$	\$ 20,000		\$ 20,000
6. State Agency Fees**	\$	\$ 141,000		\$ 141,000
7. Audit		\$	\$ 85,000	\$ 85,000
8. Needs Assessment		\$ 17,000	\$ 47,000	\$ 64,000
9. Transition Planning		\$	\$ 240,000	\$ 240,000
10. County Administration			\$ 185,000	\$ 185,000
11. Land Value			\$ 387,000	\$ 387,000
<b>TOTAL PROJECT COSTS</b>	<b>\$ 30,000,000</b>	<b>\$ 2,389,333</b>	<b>\$ 944,000</b>	<b>\$ 33,333,333</b>
<b>PERCENT OF TOTAL</b>	<b>90.00%</b>	<b>7.17%</b>	<b>2.83%</b>	<b>100.00 %</b>

\* Additional Eligible Costs: This line item is limited to specified fees and moveable equipment and moveable furnishings (eligible for state reimbursement or cash contribution), and public art (eligible for cash contribution only)

\*\* For State Agency Fees: State reimbursable costs include Real Estate Due Diligence only. State Fire Marshal fees may only be claimed as cash match.

Provide an explanation below of how the dollar figures were determined for each of the budget categories above that contain dollar amounts. Every cash contribution (match) line item shall be included with a reporting of the full amount budgeted unless a line item is not an actual cash contribution project cost for the county. (In that case, indicate so below.) For each budget category explanation below, include how state financing and the county contribution dollar amounts have been determined and calculated (be specific).

1. **Construction (includes fixed equipment and furnishings) (state reimbursement/cash match):** Construction costs were determined by estimate based on component square footage costs from a preliminary program. The different components are Site Work, Housing Areas, Health Services, Administration / control and Program Services. In addition, the required escalation to start and mid-point of construction were added to the base construction cost. After escalation a 10% construction contingency was added.

2. **Additional Eligible Costs (specified allowable fees, moveable equipment and furnishings, and public art)**
  - a) **Define each allowable fee types and the cost of each:** Utility connection fees are included in this under cash match of \$170,000
  - b) **Moveable equipment and moveable furnishings total amount:** Total Budgeted cost for movable furnishings and equipment to include items such as computers, desks, chairs, etc. totals \$1,600,000.
  - c) **Public art total amount:**

3. **Architectural(state reimbursement/cash match):**
  - a) **Describe the county's current stage in the architectural process:** The current stage of the architectural process is the preliminary plan stage where a needs assessment, program and master site plan diagram have been completed.
  - b) **Given the approval requirements of the State Public Works Board (SPWB) and associated state reimbursement parameters (see "State Lease Revenue Bond Financing" section in the RFP), define which portions/phases of the architectural services the county intends to seek state dollar reimbursement:** The county will not be seeking reimbursement for Preliminary Plans, Bridging Documents and the RFP process to choose design build teams.
  - c) **Define the budgeted amount for what is described in b) above:** The budgeted amount for item b) above is based on approximately 5% of the construction costs
  - d) **Define which portion/phases of the architectural services the county intends to cover with county contribution dollars:** The County intends to cover specialty consultants with cash match dollars for soils analysis and site surveys plus the design build architect's fees.

**Define the budgeted amount for what is described in d) above:** Budget amount for item d) above is based on approximately 5% of the construction costs.

4. **Project/Construction Management - Describe which portions/phases of the construction management services the county intends to claim as:** The county intends to use state funds for construction management services to include testing, inspections and commissioning. The county also intends to use cash match funds for construction management during the criteria and bridging phases
  - a) **Cash \$741,333**
  - b) **In-Kind**
5. **CEQA – may be state reimbursement (consultant or contractor) or cash match**  
The county will use this as cash match of \$20,000
6. **State Agency Fees – Counties should consider approximate costs for the SFM review which may be county cash contribution (match). \$16,000 for the due diligence costs which may be county cash contribution (match) or state reimbursement.** State Agency Fees includes \$125,000 for State Fire Marshall and \$16,000 for due diligence costs for a total of \$141,000.



7. **Audit of Grant - Define whether the county is intending to use independent county auditor (in-kind) or services of contracted auditor (cash) and amount budgeted:** The county is intending to use independent county auditor. Estimated cost of \$85,000.

8. **Needs Assessment - Define work performed by county staff (in-kind), define hired contracted staff services specifically for the development of the needs assessment (cash match):** County Staff who participated are outlined below for a total in-kind match of \$47,000. The county hired DLR Group to perform a needs assessment update, program and help with grant writing. Total cost of this was \$16,590 (rounded to \$17,000) of cash match.

County Staff hours performed for the Needs Assessment

Erik Carlsen - \$94.60	30 hours	\$2838.00
Aaron Limoge - \$55.74	50 hours	2787.00
Stacey Toy-Denardi - \$58.01	30 hours	1740.00
Laura Sanchez - \$55.90	25 hours	1379.50
Rebeca Lyke - \$63.77	80 hours	5101.00
Brian Paris - \$61.24	15 hours	918.00
Lt. Scott - \$102.01	20 hours	2040.00
Captain H - \$146.18	20 hours	2923.00
Jake Mucher - \$58.30	40 hours	2332.00
Mark G. - \$94.57	25 hours	2364.00
Carol - \$112.75	200 hours	22,500.00
Rosie - \$89.69	5 hours	448.50
<b>Total \$47,371 (rounded to \$47,000)</b>		

9. **Transition Planning – Define work performed by county staff (in-kind), define the staff hired specifically for the proposed project (cash match):** The County will provide transition planning staff to be associated with the project to participate in the design and transition from construction to operations. County staff is defined below and estimated at \$240,000 of in-kind match.

<u>Project Cost</u>	<u>Yearly Hours</u>	<u>Time Ratio</u>	<u>Rate</u>	<u>Annual Rate</u>	<u>Life of</u>
Jake Mucher	380	4 years	58.30	22,620.00	90,480.00
CO1-	760	1 year	45.00	34,200.00	34,200.00
Lyke	73	4 years	63.77	4,672.00	18688.00
Sanchez	36	4 years	55.90	2,016.00	8,064.00
Captain	43	4 years	146.18	6,278.00	25,112.00
Carol	73	4 years	112.75	8,176.00	32,704.00
Dave P.	73	4 years	102.01	7,446.00	29,784.00
<b>Total \$ 239,032 (rounded to \$240,000)</b>					

10. **County Administration – Define the county staff salaries/benefits directly associated with the proposed project.** The following is an estimate of county staff time involvement of \$185,000.

<u>Person</u>	<u>Time Ratio</u>	<u>Hrs</u>	<u>#Years</u>	<u>Rate</u>	<u>Cost</u>
Rob		15	4	\$150	\$9,000
Val		15	3	\$135	\$6,075
Jerry		150	4	\$138	\$82,800
Randy		150	2	\$121	\$36,300
Shawna		15	3	\$95	\$4,275
Dennis		70	3	\$138	\$28,980
Lisa		50	3	\$121	\$18,150
Total:					<b>\$185,580 (rounded to \$185,000)</b>

11. **Site Acquisition - Describe the cost or current fair market value (in-kind):** Fair market value of land based on appraisal totals \$387,000. Professional appraisal was completed by Bender-Rosenthal Incorporated.

## SECTION 3: PROJECT TIMETABLE

Prior to completing this timetable, the county must consult with all appropriate county staff (e.g., county counsel, general services, public works, county administrator) to ensure that dates are achievable. Please consult the “State Public Works Board (State Capital Outlay Process)/Board of State and Community Corrections Processes and Requirements” section, page 30 of the RFP for further information. Complete the table below indicating start and completion dates for each key event, including comments if desired. Note the required time frames for specific milestone activities in this process. The BSCC Board intends to make conditional awards at its June 2017 board meeting.

KEY EVENTS	START DATES	COMPLETION DATES	COMMENTS
Site assurance/comparable long-term possession <u>within 90 days of award</u>	7/3/2017	11/3/2017	
Real estate due diligence package submitted <u>within 120 days of award</u>	7/3/2017	12/15/2017	
SPWB meeting – Project established <u>within 18 months of award</u>	7/20/2017	9/8/2018	
Schematic Design with Operational Program Statement <u>within 24 months of award</u> (design-bid-build projects)	NA	NA	NA Design Build
Performance criteria with Operational Program Statement <u>within 30 months of award</u> (design-build projects)	9/11/2018	3/9/2018	2 Wks for SFM Review
Design Development (preliminary drawings) with Staffing Plan	NA	NA	NA Design Build
Staffing/Operating Cost Analysis approved by the Board of Supervisors	9/11/2017	11/10/2017	
Construction Documents (working drawings)	5/13/2019	5/8/2019	11 Wks for SFM / BSCC Review
Construction Bids or Design-Build Solicitation	3/12/2018	11/9/2018	Design Build Solicitation
Notice to Proceed <u>within 42 months of award</u>	11/12/2018	5/13/2019	
Construction (maximum three years to complete)	3/6/2020	9/17/2021	
Staffing/Occupancy <u>within 90 days of completion</u>	9/20/2021	10/22/2021	

## SECTION 4: FACT SHEET

To capture key information from Section 5: Narrative, applicants must complete this Fact Sheet. Minimal information is requested. Narrative information or explanations are not to be included on this Fact Sheet nor as part of the tables in this section. Explanations of what is provided in these tables may be included in the Narrative section of the Proposal Form. Proposal narratives may include reference back to one or more of these specific tables (e.g., refer to Table 3 in Section 4 Fact Sheet).

**Table 1: Provide the following information**

1.	County general population	373,796
2.	Number of detention facilities	2
3.	BSCC-rated capacity of jail system (multiple facilities)	912
4.	ADP (Secure Detention) of system	713
5.	ADP (Alternatives to Detention) of system	500
6.	Percentage felony inmates of system	79%
7.	Percentage non-sentenced inmates of system (this is not for the pretrial information that is requested in the rating criteria Section 5)	53%
8.	Arrests per month	288
9.	Bookings per month of system	828
10.	“Lack of Space” releases per month	130

**Table 2: Provide the name, BSCC-rated capacity (RC) and ADP of the adult detention facilities (type II, III, and IV) in your jurisdiction (county)**

	Facility Name	RC	ADP
1.	Auburn County Jail Type II	492	343
2.	South Placer County Jail Type II	420	370
3.			
4.			
5.			
6.			
7.			
8.			

**Table 3: List of the offender assessments used for determining programming**

<b>Assessment tools</b>		<b>Assessments per Month</b>
1.	Pretrial EMP	25
2.	SOR	189
3.	EMP 1230.017	2
4.	Work Release	10
5.	Vol. EMP	56
6.	Vol. Work Release	181
7.	Drug Court	33
8.	Adult Placement	6

**Executive Summary:**

The Placer County Sheriff's Office operates a Type 2 and 4 adult correctional facilities in Auburn and in Roseville. The Auburn facility was built in 1985 and over subsequent years, included additions designed to address overcrowding. The South Placer Jail was opened in 2014, and while this facility contains modern efficiencies, its design pre-dated changes to our state's criminal justice system. Neither facility was designed for delivery of evidenced based programs, treatment, education or vocational training required with long term incarceration. Placer County proposes construction of a new facility, called the SPIRIT facility, South Placer Inmate Rehabilitation and Instructional Training Center, at the newer South Placer Jail Campus, and the subsequent decommissioning of beds at the older, outdated housing unit at the Placer County Jail that is incompatible for delivery of programs, services and vocational training. The design, location and intent of the facility proposed in this application will be focused on delivery of programs, education, treatment, vocational training and re-entry preparation. Locating this proposed facility at the newer South Placer Jail campus takes advantage of modern efficiencies, existing staff and easy access for county stakeholders. By creating a facility specific to this purpose, Placer County intends to create a climate designed to improve inmate outcomes within the targeted inmate population. At the present time, approximately 27% of qualifying inmates receive such services in the Placer County Jail. On-going operational costs for the facility are addressed with the decommissioning of outdated housing beds. On-going costs for programs and services will be realized from existing services transferred to the new facility, as well as expansion of existing funding mechanisms used for current programs.

**Responses to Section 5 Narrative:**

1.	<p><b>STATEMENT OF NEED: What are the safety, efficiency, and offender programming and/or treatment needs addressed by this construction proposal? Please cite findings from the needs assessment (through 2019) submitted with this proposal.</b></p>
<p><b>General Merit Factors:</b></p>	
G:1A	<p><b>To what extent does the need described in the proposal match the legislative intent of SB 844?</b></p> <p><b>Response:</b> The focus of SB 844 is to improve our adult criminal justice housing system within Placer County. Placer County will place a strong emphasis on expanding all program, treatment and behavioral treatment space, which will provide a critical state purpose by promoting and improving the lives of those incarcerated by reducing recidivist and criminogenic behaviors. By providing improved housing with a specified emphasis on expansion of programming and treatment space we will enhance public safety by providing increased access to appropriate programs and treatment. This is not only going to improve the lives of our incarcerated individuals by providing important opportunities and will assist to improve the families of those incarcerated by providing face to face visitation access, which will support family development and well-being. Placer County current needs assessment document identifies deficiencies regarding inmate housing, programming and treatment opportunities in the Auburn Jail Facility. The Auburn Jail facility is currently rated at 492 beds. Fifty five percent of inmates incarcerated are located in Housing Unit 3. Housing Unit 3, is an outdated, unsafe and severely</p>

	<p>space challenged unit, which serves the larger portion of Auburn’s medium risk inmates. It is this population that would best benefit from programming, education, treatment and vocational training. The goal of Placer County is to construct a new facility at our South Placer Jail Campus to accommodate this immediate and growing need of our impacted adult jail population. By providing educational programs, treatment options, life-skills training, behavioral treatment and vocational training to these inmates would exceed the legislative intent and provide a suitable safe environment.</p>
<p><b>G:1B</b></p>	<p><b>Does the applicant provide a compelling case for the use of state financing to meet this need?</b></p> <p><b>Response:</b> The Placer County Jail Housing Unit 3 contains four direct supervision male dormitory type pods for a rated bed capacity of 212 and 2 indirect female supervision pods (celled) for a total of 64. The total rated bed capacity of HU3 is 276 inmates. The design of housing unit 3 was the result of needed bed space in direct response to a consent decree filed with the Eastern California Court District on April 9, 1992 to house low-medium security inmates. Housing Unit 3 is outdated, extraordinary small and compacted. Housing Unit 3 provides no programming, treatment, educational, any type of training space and no vocational training space whatsoever. This lack of functional space severely limits our ability to provide appropriate services to our inmate population. AB 109 and Prop 47 have changed the inmate demographics and levels of offender housing in our dormitory areas. The Auburn facility design is insufficient to meet the legislative intent for treatment,</p>



programming, behavioral needs, vocational training, life-skills for the low to medium offenders. Housing Unit 3 requires a disproportionate amount of resources to operate safely. Due to design limitations, safety of the inmates and staff has required elevated staffing. Additionally, this unit does not afford our ability to safely or easily provide a multitude of programs that could ultimately serve to benefit this portion of our inmate population. Due to our extreme lack of space, the Auburn Jail can only reach 27.7% of medium risk inmate population and only 19% of low risk inmates with any type of meaningful services. Due to our complete lack of vocational training space, the Auburn Jail is not able to reach **any** of our current inmate population. Placer County is certain our inmate population would greatly benefit from replacement housing specifically designed for behavioral, re-entry, programs, life-skills, educational, socialization programs that foster flexibility for treatment which are not currently available for this cross section of inmates. The new facility will reach the entire inmate programming needs with consolidation on one site for efficiency in operations and staffing, which would allow for controlled management of this inmate population.

**How well is the description of need supported by evidence provided by the applicant?**

**G:1C**

**Response:** Placer County's strategic plan includes construction of a secure facility with inmate housing at the South Placer Jail Campus. The SPIRIT facility will incorporate specific areas for in-custody treatment, traditional education, enhanced vocational training, behavioral health and drug treatment

and life skills training. The housing would connect to a centralized area of classrooms, therefore inmates would receive treatment or training based on their needs without impacting the larger South Placer Jail Facility. The safety and security of such a design would allow for minimal and safe movement of all inmates. Placer County Sheriff's Office shares an existing close collaborative effort with Placer County Probation, Health and Human Services, Collaborative Court Commission, Sacramento County Office of Education and partners in the private sector to provide education, treatment and vocational training with a strong emphasis on evidence based practices. The construction of a facility specifically to address in-custody treatment options, vocational training, evidence based treatment, would significantly expand our collaboration with partner agencies to serve and enhance opportunities for favorable outcomes along multiple classifications.

Placer County proposes to use the state funds to construct the following at the South Placer Jail Campus, in the following approach:

- 1) A new 60-bed Female Minimum Security Housing Unit, which will be a combination of lower security female general confinement and female re-entry beds as well, which will provide access to all programming, treatment, behavioral, life-skills training in a classroom setting or vocational shop space. In-person visitation will be readily accessible within the new SB 844 facility and will accommodate and exceed current visitation schedules.
- 2) A new 60-bed Male Housing Unit, which will be a combination of

	<p>lower/medium security male inmate population as well as re-entry beds, which will provide access to all programming, treatment, behavioral, life-skills training in a classroom setting or vocational shop space. In-person visitation will be readily accessible within the new SB 844 facility and will accommodate and exceed current visitation schedules.</p> <p>3) Placer County will provide extensive education programs, vocational programs, re-entry programs, behavioral and life skills training for inmates in new classrooms and new vocational shop facility.</p> <p>4) This facility will fully integrate inmate housing areas with programming spaces, facilitating easy access to education, vocational training and treatment programs by inmates housed within the new facility.</p> <p>5) Administrative, security, visitation, and processing areas are built within the new facility.</p> <p>6) Staging areas for food service, janitorial and laundry facilities to address the additional inmate capacity.</p> <p>7) Upgrades to site infrastructure for utilities, fencing and parking.</p>
--	---

2.	<b>SCOPE OF WORK: Describe the areas, if any, of the current facility to be replaced or renovated, and the nature of the renovation, including the number of cells, offices, classrooms or other programming/treatment spaces to be replaced or added and the basic design of the new or renovated units.</b>
----	---

<b>General Merit Factors:</b>	
<b>G:2A</b>	<p><b>How will the planned replacement, renovation or new construction meet the needs described in Question 1 (Statement of Need)?</b></p> <p><b>Response:</b> Housing Unit 3 at the Auburn Main Jail will be decommissioning 120 beds following completion of a new facility funded by this proposal.</p> <p>Housing Unit 3 is a combination of dormitory and celled housing constructed in the early 90's to address overcrowding with reduced costs. This facility was never designed to meet the current need for programming, educational and vocational training. Additionally, following passage of Realignment legislation, this facility has been the source of frequent disciplinary and safety issues. To maintain safety, staffing levels have been increased beyond the original design intent of the housing unit. Housing Unit 3 consists of four dormitory housing units containing 212 male beds, and 64 female beds in celled housing. The new facility funded by SB844 will be constructed at the newer South Placer Jail. This facility was opened in 2014 and was funded entirely by county resources. While the South Placer Jail was designed with safety and efficiencies as a cornerstone of the design, the facility was designed prior to the passage of both Realignment and Prop 47. As a result, the existing facilities do not meet all of the needs for the enhanced inmate services required to directly address recidivism. However, the footprint of the facility and adjacent property was intended for further expansion projects, which makes the South Placer Jail an ideal location for a modern facility designed to address modern standards when providing inmate services.</p>

Construction of a new facility funded through SB844 will serve to augment the efficiencies designed into the South Placer Jail. This facility is designed and intended to address recidivism by providing educational programs, treatment services, life skills training and vocational training to a larger percent of our inmate population. The new facility will contain housing units for both male and female inmates integrated into a facility focused on the physical infrastructure and spaces needed to provide ready access to the services that may improve future outcomes for our inmate population. Our target goal is to provide these services to 100% of those inmates in the proposed housing units, who will benefit from direct intervention.

The facility design incorporates the needs of community stakeholders who provide many of the services for our inmates, and who will be involved in the expansion of the services this facility will provide. A core group of our stakeholders include: County HHS, Placer Adult Education, Sacramento County Office of Education, Placer County Probation and involved community organizations.

The facility design will include housing for men and women, re-entry beds and associated space needs, educational and multi-skill vocational training spaces, mental health and medical treatment spaces and programing spaces for evidence based services. Inmate visitation will be conducted within the newly constructed SB 844 facility. A modern streamlined visitation area designed with operational efficiencies will meet BSCC standards, which will allow for room with families to speak with their loved ones. Inmates will experience great

	<p>benefit from in-person visitation, with the visitor able to see through a clear glass partition and talk on an intercom system with the inmate, with a schedule of at least 2 visits per week. Additional special visits will also be accommodated when appropriate.</p> <p>Staff spaces will include housing unit security, inmate medical and mental health treatment rooms, administrative offices, interview rooms and staff break and restrooms.</p> <p>The new facility will be staffed with position allocations that are reassigned from housing units at the Auburn Main Jail that will be decommissioning beds following completion of this new facility. This facility will conform to all Title 15 and 24 requirements.</p>
G:2B	<p><b>How well does the proposed project plan suit general operational requirements for the type of facility in the proposal, including factors such as safety, security and efficiency?</b></p> <p><b>Response:</b> The implementation of both Realignment and Proposition 47 has resulted in changes to our inmate population at both Placer County Jail Facilities. While the newer South Placer Jail was designed with efficiency and safety as a cornerstone of design, neither facility was designed for long term housing or the evidence based programs at the foundation of modern correctional philosophy. However, the South Placer Jail was designed and built with future expansion projects as part of its original intent, and construction of a modern facility with evidence based programming as its core purpose will serve to augment the long term of needs of our community and inmate population.</p> <p>Construction of this facility will allow Placer County to address that segment of</p>

the inmate population most suited for intervention. By placing inmates involved with programming into a facility specifically designed for this purpose, inmates who are less amenable to programming will be housed in existing facilities at the South Placer Jail, and prevented from influencing the outcomes of those inmates involved in programs. Inmate housing for this facility will be constructed around areas dedicated to educational, vocational and treatment programs, as well as areas dedicated to re-entry programs. By separating these inmates from those less amenable to programming, we can increase successful outcomes for our inmate population. Design of this facility will incorporate modern standards for inmate supervision, and will include design features that address PREA guidelines in programming spaces and housing units. Placer County efforts to combat sexual abuse in the correctional environment are as follows:

The Auburn Jail and South Placer Jail both have established guidelines in preventing, detecting and responding to allegations of sexual assault, sexual misconduct and retaliation within both of our facilities. The Placer County Sheriff's Office has zero tolerance for inmate to inmate sexual abuse and staff to inmate sexual abuse. The Placer County Sheriff's Office will investigate every allegation of sexual abuse. Our guidelines are set to maintain compliance with state and local regulations, policies and procedures required to maintain officer safety, safety and security of the facility, or procedures intended to safeguard the health and welfare of inmates. Our policy has further purpose to provide guidelines for the successful community re-entry of sexual

abuse/harassment victims and treatment for the perpetrators. Several of the ways both facilities are preventing, detecting and responding to allegations are as follows: Stand-Up Placer (a local organization) has pre-recording before each outbound inmate call where an inmate can anonymously report a sexual assault. Informational paper with sexual assault reporting options & Stand-Up Placer contact information is provided inside each inmate property bag and given upon release of inmate. PREA/sexual assault reporting information posted in each housing pod in both facilities. Mandatory duty Sergeant PREA checks per shift written in Sheriff's Office policy. Employees are required to review and sign a PREA Policy acknowledgment yearly. Four PREA Training Facilitators for the Corrections Division. Civilian/non-sworn/sworn Placer County staff given PREA training annually. 3<sup>rd</sup> party vendors, clergy, volunteers, teachers, etc. given PREA training annually.

Housing areas will be celled housing, and include both direct and indirect supervision as well as modern video surveillance and intercom communications. Vocational and educational spaces will include the same modern safety and security provisions already incorporated into the design of the South Placer Jail, which provides a maximum of safety provisions and inmate oversight, along with increased efficiencies for inmate movement.

Separation of classifications within the facility will be enhanced by building housing units with direct access to vocational, educational and programming areas from the housing areas and will be readily supervised using both direct and indirect staff supervision. Staffing for this new facility will be provided by



	<p>those staff allocations freed up when older housing Auburn Housing Unit 3 has decommissioned 120 beds upon completion of the new facility.</p>
<p>G:2C</p>	<p><b>Where applicable, how well does the proposed project meet specific needs for programming and treatment space?</b></p> <p><b>Response:</b> With this proposal, the objective of the Placer County Sheriff's Office, in conjunction with our county and community stakeholders, is to provide programming, vocational training and or treatment services to 90% of our total inmate population that qualify for such services. With our current facilities, only 27% of those who otherwise qualify are able to engage with the services we currently provide due to lack of space. Placer County is in an ideal position to expand on a variety of services that we currently provide. An index of current services includes evidence based CoRR and MRT; Educational programs to include GED, High School Diplomas and Academic Brush Up, Computer Skills, Literacy Programs and Culinary Arts; Re-Entry Programs to include PREP (in-custody), Parenting, Anger Management, Batterers Programs and Courage to Change; Transitional PREP (out of custody); Vocational Training in the form of construction, electrical skills as well as Life Skills Training programs; Traditional in-custody programs that address mental health, substance abuse and veteran services. Governmental stakeholders who have already partnered with Placer County Corrections include Probation, HHS, Placer School for Adults and Sacramento County Office of Education. Community partners include faith based organizations, non-profit substance abuse organizations and private entities involved with life skills training. A</p>

summarized description of programs is available in the needs assessment accompanying this application. The intended design of this facility will maximize our ability to provide both the current services as well as expanded evidence based programs, vocational training and re-entry programs. By constructing a facility that includes housing units dedicated to these programs and the spaces where the services are provided, we can maximize the number of inmates who can participate in programs designed to provide them with skills necessary for success upon release. This facility design incorporates programs and vocational training into the overall design of the housing units. Inmates housed within this facility are those who qualify for, and are willing to participate in programs designed to enhance their opportunities following release. Educational classrooms, treatment spaces, medical services and vocational training areas are part of the core design of the facility. Housing units will include both individual programming spaces for housed inmates, as well as access to larger multi-skill vocational spaces where employable skills can be taught to the inmate population. In addition to providing a variety of in-custody evidenced based programs, treatment and vocational skills, it is also our vision with this facility to include a re-entry program designed to increase successful outcomes, enhance employment opportunities and reduce recidivism. We envision this program as a partnership between Corrections, Probation, HHS and community partners.

**Special Factors (GC section 15820.946, subd. (c)) Funding Consideration:**

S:2A	<b>Does the county plan for seeking to replace compacted, outdated, or unsafe housing capacity that will also add treatment space? or,</b>
------	--

	<p><b>Response:</b> Housing Unit 3 at the Auburn Main Jail will be decommissioning 120 beds pursuant to the opening of a new facility funded by this proposal. Housing Unit 3 was constructed in the early 90's to address overcrowding, and includes both direct supervision dormitory housing and indirect supervision celled housing. Housing Unit 3 was originally designed for low level of classification, and is not suited for the impacts associated with Realignment or the implementation of Prop 47. As a result, this housing unit is now home to sophisticated "prison level" inmates who are serving longer sentences. To address safety as well as disciplinary issues that have developed, we have been forced to double staffing to insure inmate and staff safety. In addition, this housing unit was never designed to accommodate evidence based programs, multiple treatment programs, educational programs or vocational training. Qualifying inmates housed within this housing unit have very limited access to programs, and no access to vocational training. Construction of a facility dedicated to evidence based practices will allow Placer County to decommission 120 beds in Housing Unit 3, reclassify the inmate population based on qualifying factors, and provided enhanced access to evidence based services at the Spirit facility at the South Placer Jail.</p>
S:2B	<p><b>Or, Does the county plan for seeking to renovate existing or build new facilities that provide adequate space for the provision of treatment and rehabilitation services including mental health treatment?</b></p> <p><b>Response:</b> The new facility constructed with this proposal will replace existing housing beds decommissioned upon completion of the new facility. The new</p>

facility will include dedicated treatment space for medical and mental health treatment, and ample additional classroom space will provide opportunities for both individual therapy, as well as group therapy aimed at both mental health treatment as well as substance abuse treatment. By housing qualifying inmates in a facility dedicated to treatment and vocational training, inmates will be separated from negative influences of non-qualifying inmates and increase their opportunity for successful transition into life outside of custody.

<p>3.</p>	<p><b>PROGRAMMING AND SERVICES.</b> Describe the programming and/or treatment services currently provided in your facility. Provide the requested data on pretrial inmates and risk-based pretrial release services. Describe the facilities or services to be added as a result of the proposed construction; the objectives of the facilities and services; and the staffing and changes in staffing required to provide the services.</p>
<p><b>General Merit Factors:</b></p>	
<p>G:3A</p>	<p><b>How clearly described are the facility's current programming and/or treatment services?</b></p> <p><b>Response:</b> Placer County currently offers a wide variety of in-custody educational programs, as well as programs grounded in evidence based principals and best practices. Placer County also offers treatment programs and re-entry programs, utilizing the same evidence based best practices, all of which will be expanded following completion of this proposed project. Additional educational, vocational and out of custody programs, community partners and funding streams have been identified for deployment upon operational opening of the new facility. It should be noted that many of the current programs operate collaboratively with a re-entry team consisting of</p>

county and community collaborators. Current programs include:

**Preparation for the GED Test:** Classes are held in the following subjects; Math, English Language Arts, Science and Social Studies. Working closely with our Placer School for Adults partners we have increased proficiency testing to a weekly model.

**Preparation for High School Diploma:** Individuals having the majority of high school prerequisites can obtain their High School Diploma while in-custody. The Placer School for Adults works with the last high school attended and gives the student instructional course work and tests to complete High School Diploma requirements.

**Math-Academic Brush Up:** Individuals already possessing a high school diploma, GED or higher education can continue education through individual mathematical course work in algebra, trigonometry, calculus and statistics.

**Literature- Academic Brush Up:** Individuals already possessing a High School Diploma, GED or higher as well as selected inmates can enroll in advanced literature analyzing and discussing selected readings. Individuals with reading skills below 8<sup>th</sup> grade are assigned to individual reading tutors for two sessions per week/ 1.5-2.0 hours a session.

**Career Technical Education- Basic Computer Application:** Writing assignments, practice, drills and practice assignments specifically aimed at those nearing the GED test dates. Individuals develop the basic skill sets to move onto more challenging computer applications. 30 hours of instruction for each Word, Excel and Power Point. Through exercises, drills and testing,

Certificates of Mastery are given to successful students. A companion curriculum is being developed incorporating resume writing with interviewing skills and public speaking.

**CoRR: Community Recovery Resources (Beyond Bars)** CoRR staff enter the jails weekly interviewing and assessing pre-selected offenders unable to participate in programming due to short term sentences and approaching release dates. Exit planning and needs discussed as well as appropriate treatment and services if needed.

**MRT: Moral REconation Therapy, PES (Pacific Educational Services):** PES staff work closely with re-entry staff interviewing and assessing pre-selected inmates at the South Placer jail unable to participate in programming due to short term sentences and approaching release dates. Exit plans are completed and needs for treatment are determined as appropriate.

**Meditation:** A dedication toward harmlessness with the ultimate aim of the practice being the end of suffering, stress, anxiety, fear, hatred and delusion. Due to space limitations this offering has been suspended but will reconvene as space allows.

**Parenting: The Nurturing Parent** Evidence based principles and practices establishing the six protective factors that will prevent child abuse and neglect. Nurturing and Attachment, Parenting Knowledge, Youth Development, Parental Resilience, Concrete Support Services for Parents, Social and Emotional Competence of Children.

**Alternative to Violence Project (AVP):** Project is a multi-cultural organization

of volunteers offering experiential workshops that empower individuals to lead non-violent lives through affirmation, respect for all, community building, cooperation and trust.

**Military Veterans:** Collaboration with the Placer County Veterans Officer provides inmates seeking information on possible government/ local benefits for themselves or families can submit paperwork which is directed to the County Veterans Office.

**Mental Health:** Our Auburn LCSW started possibly the first program of its kind with in-custody inmates. The Socialization Project convenes once a week at the Auburn jail. Under the supervision of the LCSW and jail staff, these mental health inmates, normally segregated from the general populations and each other, are brought together for group therapy.

**The Literacy Program:** Sponsored by the Placer County Library System through the Placer Adult Literacy Service (PALS). A literacy specialist conducts a one-on-one comprehensive literacy assessment. PALS provides inmates with tools to change their lives by giving them the reading, writing and basic math skills needed to move into the in-custody GED program or transition to the out of custody Re-Entry program.

**Narcotics Anonymous (NA):** Fellowship meetings where recovering addicts share messages and advice to incarcerated individuals. Resources are made available to inmates to take advantage of weekly group NA programs offered to the various in-custody classifications. One-on-one NA meetings for administratively segregated or two officer move inmates are encouraged.

**Alcoholics Anonymous (AA):** Volunteers hold group meetings weekly as space allows. One-on-one AA meetings for administratively segregated or two officer move inmates are encouraged and by appointment.

**Chaplain Program:** Every religious group/church in the county has volunteer facilitators from all denominations to host group individual religious prayer or devotional services.

**Sacramento County Office of Education (SCOE)** In 2014/15, SCOE via the RFP process provides CBT/ CBI other Re-Entry services to offenders both in and out of custody. As a core member of the Re-Entry team SCOE shares every resource available to offenders equally. SCOE is more than a service provider, SCOE Transitional Specialists have integrated into the in-custody routine providing CBT to medium/high risk offenders. Since the 2015 SB863 application the Correctional Assessment and Intervention System (CAIS) a validated risk/needs assessment tool is expanding in use at both jails with the offender populations. CAIS assessments identify specific factors causing an individual's risk level and target relevant CBT to address and eliminate those factors. SCOE in-custody programs offerings includes:

**Parenting:** Focusing on offenders with long incarceration histories and the effects on children. Teaches techniques to and the importance of regaining the parent/child relationships in healthy and meaningful ways.

**Anger Management:** Addresses lack of appropriate coping skills and root causes of anger and stress. How criminal behavior is one manifestation of the underlying causes. The damaging effects of long term bitterness, hurt and



jealousy.

**Courage to Change:** Intervention curriculum utilizing interactive journaling with 10 specific topics ranging from social values, responsible thinking, peer relations and self-control.

**52 Week Batterers Program Identifying the types of violence:** emotional, verbal, physical and sexual. Curriculum to educate abusers and overcome violent and unacceptable criminal behaviors. Through cognitive awareness.

This course is accepted by the Placer County Courts.

**The Placer Re-Entry Program (PREP):** PREP is used in terms of anything related to an offender entering the community from an incarceration. All CBT programs offered to the offender population are delivered using best practices and evidence based principles. SCOE Transition Specialists work collaboratively and daily with all Re-Entry staff and other service providers with the single purpose of reducing the cycle of recidivism through targeted assessments, appropriately dosed programming and continuous engagement through the change process. PREP or Re-Entry programming aims to reduce recidivism in the offender population by looking at the individual's criminogenic risk factors and cognitively addressing those wrongly held attitudes and beliefs that contribute to criminal thinking and behaviors.

G:3B

**If improvements to programming and/or treatment services are expected as a result of the planned construction project: Are the improvements to programming and/or treatment services clearly described?  
How strong is the evidence provided by the applicant that the programming and/or treatment services planned for inmates upon project completion will help reduce recidivism or meet inmates' health and treatment needs while incarcerated?  
What are the applicant's current efforts and the plan to provide a post-**

**release continuum of care? Describe the applicant's efforts to collaborate with the community based partners in this effort.**

**Response:** Placer County proposes to expand and add the following educational, programming resources and vocational training to the existing jail programs, through focused facility construction space additions and our plan to provide post continuum of care in collaboration with our community based partners:

**Additional Basic Adult Education courses (Expanded):** Due to lack of space, inmates of the same classification needing little to moderate teacher assistance must compete for teacher attention with those individuals requiring extensive one-on-one assistance. With additional classroom space to allow distance learning, the jail could run concurrent basic adult education programs.

**Academic Brush Up (Expanded):** With additional housing/classroom space, those individuals already in possession of a high school diploma or GED certificate could work on deficient academic areas.

**Art Therapy, Mental Health Program (New):** Art Therapy program for inmates with acute mental health issues and those suffering with PTSD for both military veteran's in-custody and other sufferers. Participants in this programming improve their overall functioning and social interaction skills.

**SCOE In-Custody Construction Trade Class Curriculum (New):** In partnership with SCOE/Northern California Construction Training (NCCT), an agreement will bring out of custody NCCT classroom curriculum into the jail. This program would augment and prepare those inmates in Re-Entry for

seamless transition to the PREP NCCT out of custody program. Providing this program to inmates that may not assess a high risk to reoffend but are without employable skills/direction or career aspirations, would benefit the inmate and community as well. Since the out of custody NCCT program has slotted seats for non-“Re-Entry” individuals, this would be an option for younger inmates without a plan for employment.

**Meditation and Alternatives to Violence (AVP) (Expanded):** With space additions, more groups of many classifications can attend. When small groups of a larger population attend the three day AVP course, the increased positive inter-personal communication skills acquired are strong.

**Culinary Vocational Program (Restart/Expanded and New):** The South Placer Jail kitchen classroom space would allow a fully functional culinary program. Culinary Arts includes classroom instruction as well as hands on kitchen experience. Expanded classroom space would provide an area for written and practical test would cover topics including: sanitation and effective sanitary practices, biological hazards, typical kitchen/ cooking equipment safety and operations, emergency procedures and food service preparation.

**Welding Technology and Metal Fabrication Vocational (NEW):** The Re-Entry program would add welding to the in-custody programs. Placer County School for Adults would teach this class. Placer County has a demand for welders in the area and certified welders are in demand across the country along with teaching problem solving with metal design and fabrication.

**Electrical and Wiring Technology Vocational Program (NEW):** The

Electrical and Wiring Technology would prepare Re-Entry inmates for out of custody PREP construction training. Electrician trade school programs are nine months to one year. Partnering with local education resources, the in-custody program teaches basic module curriculum covering introduction to electrical theory, California related codes, motors and transformers, wiring an installation and other topics. A program agenda with distinct testable learning modules, emphasizing strong foundational knowledge. This program would be taught by Placer County School for Adults.

**C-Tech and Associates Vocational Program (NEW):** This new program specializes in telecommunication tech., copper and fiber optic networks, telephone and VoIP, audio/video systems, energy management and connecting to business. Each module provides inmates the skills to learn industry-recognized and standardized training for workforce development upon release from custody. Inmates can earn six industry credentials in 230 hours of training and also certifies females at almost three times the national average while greatly assisting the transition from incarceration to gainful employment. Placer Counties post release continuum of care is offered through our re-entry services at the PREP center, which is co-located with County Probation at the Santucci Justice Center and the newly opened PREP center in Auburn also offers CBT and CBI programs and training to medium/high risk offenders, probationers and PRCS releases and parolee's. Our community partnerships comprises of dedicated staff from Corrections, Probation, Health and Human Services, SCOE, Placer Adult Education System, Child Welfare Services,

	<p>Parole, Mental Health, Sheriff's Office personnel and faith based partnerships. The collaborative relationships of above listed agencies working together to manage our re-entry inmates to assist in post release status. Each inmate leaves with an exit plan with directed services in their individualized plan. Follow-up is conducted weekly to ensure benefits and compliance remain in effect.</p>
G:3C	<p><b>If improvements are designed to replace compacted, outdated, or unsafe housing capacity: How are the program and treatment service needs of the facility population expected or planned to be met? Are the improvements to housing deficiencies clearly described? To what extent will the deficiencies be remedied by the proposed construction?</b></p> <p><b>Response:</b> With the decommissioning of 120 beds in Auburn's, space challenged and unsafe Housing Unit 3, the proposed two new housing units and associated educational, program and vocational space would provide needed opportunities currently not available due to lack of space. With the expanded space inmates would not compete with the entire jail population for dedicated group or individual program time. Multiple Socialization groups would be held with the goal of modifying behaviors and allowing more individuals to move towards a general population status within their classification. Inmates with mental health issues historically have not been assigned Adult Education due to lack of resources and space. With the proposed new construction containing dedicated classroom and vocational spaces, this would guarantee the various adult educations as well as the planned therapy programs and other positive behavior reinforcing programs. Currently, the Mental Health socialization group is limited to 1.5hours/once a week. A sub-group of mental</p>

	<p>health inmates that are administratively segregated from the other similar but general population and each other in large part due to mental health issues are brought together by jail mental health practitioners and program in group treatment situations. This particular Socialization project has proved extremely successful however, due to lack of space in the jail, it is limited to once a week. Placer County will expand and provide increased opportunities to all inmates.</p>
G:3D	<p><b>How thoroughly does the staffing plan and lines of authority (including interagency partnerships, if relevant) in program and treatment management meet operational objectives?</b></p> <p><b>Response:</b> The staffing plans in program and treatment management is multi-faceted in teaching and facilitator resources. The unique relationship between Placer's Corrections Division and Probation Department regarding offender treatment and re-entry is strong and goal driven. The collaborative relationship between these partners has expanded to encompass many other county and private agencies with the goal of meaningful treatment, programs and services both in-custody and the community. These partners include Placer's Welcome Center for the transit population including ex-offender with duplicated services found in-custody and the PREP centers, County Health and Human services providing enrollment in the Affordable Care Act, The LightHouse providing counseling and Family Services, The Health Education Council providing nutritional guidance for individuals and families, Golden Sierra Services providing employment/career assistance for individuals and special services to those with disabilities, ACES Affordable Counseling Services facilitating the 52 week Batterers program/Parenting and Anger Management, Calworks</p>

providing benefits and social services, Placer’s Adult System of Care (ASOC) providing Alcohol and Drug counseling and treatment placement as well as mental health services. These alliances co-located within the jails and at various county locations ensure a seamless continuum of care and efficient use of resources along with the ability to track offender’s progress after release. County entities; HHS, Adult System of Care, Mental Health, Veterans services have dedicated staff and fund programs as imbedded partners through staffing, authority in program and treatment management. County Probation will continue active involvement with in-custody probationers and other specified inmates. Also involvement with the jail program curriculum and development of new classification schemes melding traditional county type classification methods/procedures with CAIS assessment tools or other novel approaches that identify and treat those factors that continue the cycle of incarceration and recidivism. Work collaboratively with Corrections in transitional programs and planning. County Probation will continue the increased involvement and early jail intervention with specified offenders and those offenders that may not have a “status” but are frequently overlooked.

**Special Factors (Gov. Code, 15820.946, subd. (b)) Mandatory Criterion:**

**The county provided documentation that states the percentage of its inmates on pretrial status between January 1, 2015 and December 31, 2015 in the narrative of question 3?**

S:3A

**Response:** The following data indicates the Pre-Trial information as reported to BSCC on a monthly basis for the timeframe requested.

2015					
Month:	ADP of Fel.	% OF ADP	ADP of Misd.	% OF ADP	Total % of ADP

County of Placer SB 844 Proposal Section 5: Narrative Attachment

Jan	296	47%	31	5%	53%
Feb	287	46%	28	4%	52%
Mar	294	48%	28	5%	55%
Apr	301	48%	34	5%	55%
May	299	47%	38	6%	54%
Jun	292	47%	43	7%	55%
Jul	303	49%	43	7%	57%
Aug	296	47%	41	7%	55%
Sep	304	46%	48	7%	55%
Oct	304	46%	51	8%	55%
Nov	312	46%	52	8%	55%
Dec	305	46%	55	8%	56%

**Provide a description of the county risk-assessment-based pretrial release program is provided in the narrative of question 3.**

**Response:** Placer County uses the following Risk Assessment for all in custody arraignments on fresh arrests and return on warrants to be completed by probation staff the following day of arrest/day prior to arraignment. The Multi-phase process utilizing Probation and Jail information systems are:

- A. Generate basic report and Interview defendant/verify information  
Address/Phone/Pending Cases/Probation Status/ Employment/Drug History/ Military/Address Verification contact.
- B. Document CLETS information. (prior conviction history)
- C. Score document based on Virginia Pre-Trial Risk assessment.

S:3B

Score of 0-1= Straight OR (Own Recognizance)

Score of 2= OR with Conditions. (Abstain terms, for example)

Score of 3= Supervised OR- Release with terms and conditions; Supervised by probation; status reports generated for the courts.

Score of 4= Pre-trial EMP Home Confinement- Release on electronic monitoring with terms and conditions; supervised by probation, earn day for



day credit for sentencing purposes; status reports generated by the court; high level of supervision.

Score of 5 or more= No Release; Probation recommends no release; bail set.

D. Copies of report recommendations to DA, Court and PD for review.

Court makes final determination and can override Probation recommendations. Probation can override final score and make adjusted recommendation based on circumstances including nature of offense, public safety consideration, additional warrants, pending cases and probation history.

4.	<b>ADMINISTRATIVE WORK PLAN: Describe the steps required to accomplish this project. Include a project schedule, list the division/offices including personnel that will be responsible for each phase of the project, and how it will be coordinated among responsible officials both internally and externally.</b>
<b>General Merit Factors:</b>	
G:4 A	<p><b>How clearly described are the elements of the work plan: timeline, assigned responsibilities, and coordination?</b></p> <p><b>Response:</b> The Placer County Sheriff's Office is committed to meeting the timeline and project schedule outlined in section 3 in this RFP. The elements of the work plan and key events are very achievable and are as follows; site assurance within 90 days of award, real estate due diligence within 120 days of award, SPWB project establishment within 18 months of award, Performance</p>

Criteria with Operational Program Statement within 24 months; staffing and Operating Cost Analysis approved by the BOS by 5-2018, Design Build solicitation by 12-2018, Notice To Proceed by 2-2019, Construction Documents 8-2019, Begin Construction 6-20-19 to End of Construction 12-2020, Staffing and Occupancy completed by 3-2021, well within 90 days of completion.

The Divisions and offices responsible for each phase of this project and their duties for implementation of project through completion and coordination of efforts are as follows: Placer County Capital Improvements Division Project Manager: Lisa James. Ms. James will oversee all elements of the process from planning stages, produce all necessary due diligence, site assurances, performance criteria documents to construction and finalization of total project. Placer County Capital Improvements Manager: Steve Newsom will oversee the project operations from beginning to completion by making timely inquiries into project goals. Placer County Fiscal Administration: Valerie Bayne will be responsible for all payments, costs and accounting receipts payable as well as accounting of PMIB monies of project from inception with this RFP to completion of the project. Placer County Correctional Facilities Coordinator: Jake Mucher is responsible for on-site jail construction of the SB 844 project and has experience in 2014 with jail construction and transition planning of the South Placer Jail build. Mr. Mucher will be involved in the daily oversight of project at the South Placer Jail construction site. Placer County SB 844 Coordinator: Sheriff's Lieutenant; Carol Walsh is responsible for the completion of the RFP, coordinating with DLR Group on the RFP, and coordination with yet to be identified contractors

	<p>throughout this project. Lt. Walsh will be the Sheriff's liaison with the BSCC, SPWB, SFM and all associated entities throughout this project as well as all county entities. DLR Group: Darrell Stelling; Contracted for Request for Proposal Completion, needs assessment, project preliminary designs; State Fire Marshall's Office: Fire Life Safety Planning during initial blueprint planning. Construction Planning and Management for bridging documents; Future bids. Design Build Project bids for architectural designs; future bids. Audit of grant: independent contractor to ensure compliance with proper use of state funds. Transition Team Planning: Placer County to plan for staffing, participate in the design process, and transition from construction to full operation of proposed facilities. Coordination for this project will include regularly scheduled meetings to monitor the overall progress.</p>
G:3 B	<p><b>Can the scope of work described in Question 2 (Scope of Work) feasibly be accomplished within the time allotted?</b></p> <p><b>Response:</b> Placer County has prior experience with construction of large jail facilities, to include the South Placer Jail campus which was fully funded by county revenues and opened in 2014. The county intends to utilize best practices learned from that project as a template for this project. Creation of a project team to include all current and future stakeholders will insure timeline goals, milestone goals and project design needs are met. These stakeholders will include those entities responsible for delivery of services and programs to the inmate population. This template for a project team has proven successful for Placer County with regard to the South Placer Jail construction project. This project will</p>

occur on the existing campus of the South Placer Jail facility, and as such, critical infrastructure to build and support an operational facility already exists, eliminating any additional time necessary to launch and complete this project. Operation of the facility within 90 days of completion will not require any unusual operational changes for the Placer County Sheriff's Office. The necessary staff to operate this facility already exist and will be transferred from a housing unit, which will be decommissioning beds under this proposal, into the facility built through this proposal. Therefore, no additional time will be required for hiring, training or deploying new staff allocations, reducing the time necessary between completion and operational opening. Mr. Jake Mucher has experiences in jail construction and transition planning of new jail projects and this will assist in accomplishing the project within the time allotted.

5.	<b>BUDGET NARRATIVE:</b> Describe the amounts and types of funding proposed and why each element is required to carry out the proposed project. Describe how the county will meet its funding contribution (match) requirements for all project costs in excess if the amount of state financing requested and how operational costs (including programming costs) for the facility will be sustained.
<b>General Merit Factors:</b>	
G:5 A	Is the allocation of effort in the budget appropriately matched to the objectives described for the project under need, scope of work, offender treatment and programming, and administrative work plan?

**Response:** The **needs** objective of the Sheriff's Office is to construct a facility appropriate to the risks of the inmate population and provide meaningful educational programs, treatment options, vocational training to those inmates that will benefit in an environment suitable for the safety of both staff and inmates. This proposed facility located at the South Placer Jail could reach the entire inmate programming needs while consolidated on one site for efficiencies in operations and staffing. The **scope of work** objectives is to decommission 120 beds in Housing 3 at the Auburn Jail as this is clearly insufficient to meet the current needs of AB 109 inmates with their level of state prison sophistication. Construction of two sixty bed housing units at South Placer Jail with associated educational, treatment and vocational training areas will assist with inmate needs to ensure inmates can realize a trade and become successful through job training, placement with a goal on reducing recidivism. The **treatment and programming** objectives are to add new and expanded education, behavioral treatment, vocational programming resources to the existing jail program through focused facility construction space additions. The efficiencies of the SPIRIT facility will be enhanced with access for Probation Health and Human Services, Educational partners and Placer Adult Education services, who all implement and provide many of these programs. The **administrative plan** is to include procurement of professional consulting services to augment county staff in the project design and construction management of the proposed facility. The consultant will assist with all facets of the project; including development of the design build for construction, development of the detailed architectural program,

	<p>preliminary design and performance criteria. The county facilities department is the lead department for planning, design and construction of the proposed project. The Placer County Sheriff's Office is to work closely with the BSCC, SPWB, SFM and will manage the project with key individuals within the Sheriff's Office by providing directives and oversight. The County financial office will be responsible for overseeing the 30 million in state funding, county cash contribution of 2,389,333, in-kind contributions of 944,000 for a total of 33,333,333. Placer County has set aside the required 10% in county match, as well as additional funds to cover excess costs, which resides in the Sheriff's Public Safety Fund. Placer County shares that the combination of all efforts required to obtain the entire objective identified for this project will produce the best and most appropriate use of state financing.</p>
G:5 B	<p><b>Are the budgeted costs an efficient use of state resources?</b></p> <p><b>Response:</b> The effective use of these state resources are defined in the careful planning phases and budgetary assurances defined in this proposal.</p> <p>The proposed facility will be constructed on the existing campus at the South Placer Jail. This campus was designed with future expansion as part of the original design, insuring that state resources dedicated to this project will be used efficiently during the construction phase. Operations, security and continued support of this facility will be sustained by pre-existing operations and services at the South Placer Jail campus, and staffing costs for this facility already exist within the current operating budget of our corrections division. A significant value will be achieved with this requested investment.</p>

G:5 C	<p><b>Rate the applicant’s plan for sustaining operational costs, including programming over the long term.</b></p> <p><b>Response:</b> Placer County plans to shift staff allocations from those beds decommissioned under this proposal to the new facility constructed with funds from this proposal. Operational costs for staffing exist within our current budget and we do not anticipate any new allocations and associated staffing costs. Many programs and services already exist within our corrections division and those services would also be shifted to this facility. Expansion of educational and vocational training programs would be funded through a combination of Average Daily Attendance revenue through our educational providers and funds from our Inmate Welfare Fund, SCOE, as well as AB86 monies through the Sierra Joint Consortium and the Placer School for Adults. These funding mechanisms will cover the current and expanded services we intend to offer.</p>
----------	--

6.	<p><b>READINESS TO PROCEED (Gov. Code, § 15820.946, subd. (b)(2))</b>  <b>Funding Preference:</b></p>
6A	<p><b>Did the county provide a board resolution: 1) authorizing an adequate amount of available matching funds to satisfy the counties’ contribution 2) approving the forms of the project documents deemed necessary, as identified by the board (SPWB) to the BSCC, to effectuate the financing authorized by the legislation, 3) authorizing the appropriate signatory or signatories to execute those documents at the appropriate times. The matching funds mentioned in the resolution shall be compatible with the state’s lease revenue bond financing. See page 2 of the Proposal Form and Instructions for more information regarding “compatible funds”.</b></p>

	<p><b>Response:</b> The Placer County Board of Supervisors has provided a Board of Supervisors Resolution, # 2017-043 satisfying the requirements of availability of adequate matching funds to the Counties contribution to the SB 844 project. In addition, the Board Of Supervisors has approved the forms and documents identified by the State Public Works Board to the Board of State and Community Corrections to effectuate the financing authorized by legislation. The Board of Supervisors has identified the County signatories to execute the appropriate documents at the appropriate time and the matching funds identified in the resolution are compatible with the states' lease bond revenue financing.</p>
6B	<p><b>Did the county provide documentation evidencing CEQA compliance has been completed? Documentation of CEQA compliance shall be either a final Notice of Determination or a final Notice of Exemption, as appropriate, and a letter from county counsel certifying the associated statute of limitations has expired and either no challenges were filed or identifying any challenges filed and explaining how they have been resolved in a manner that allows the project to proceed as proposed.</b></p> <p><b>Response:</b> Placer County Counsel's Office has provided documentation certifying the project is in compliance with CEQA. In accordance with Section 21083 of the Public Resources Code and Section 15075 of CEQA Guidelines, a Notice of Determination for a Mitigated Negative Declaration for the project was recorded and posted on February 27, 2004 by the County Clerk of Placer County. The attached letter from the Placer County Counsel's Office certified that the associated statute of limitations to challenge the CEQA determination on the project have expired and no challenges were filed. Placer County is prepared to proceed.</p>



Before the Board of Supervisors  
County of Placer, State of California

**In the matter of:**

A Resolution authorizing application to the Board of State and Community Corrections 2017 Jail Construction Financing Program, SB 844, in the amount of \$30 million to provide funding to assist with the construction of a 120-bed medium security facility and associated educational, vocational behavioral and life-skills treatment space.

Resolution No.: 2017-043

The following Resolution was duly passed by the Board of Supervisors of the County of Placer at a regular meeting held February 21, 2017, by the following vote on roll call:

Ayes: DURAN, WEYGANDT, HOLMES, UHLER, MONTGOMERY

Noes: NONE

Absent: NONE

THE FOREGOING INSTRUMENT IS A CORRECT  
COPY OF THE ORIGINAL ON FILE IN THIS OFFICE  
ATTEST

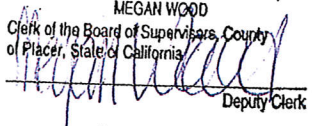
MEGAN WOOD  
Clerk of the Board of Supervisors, County  
of Placer, State of California  
  
Deputy Clerk

Signed and approved by me after its passage.

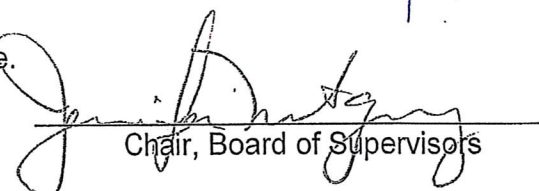
  
Chair, Board of Supervisors

Attest:

  
Clerk of said Board

---

**BE IT RESOLVED** by the Board of Supervisors of the County of Placer, State of California, that this Board hereby authorizes the Sheriff's Office to submit an application to the Board of State and Community Corrections 2017 Jail Construction Financing Program, SB 844, in the amount of \$30 million, to provide funding to assist with the construction of a 120-bed medium security facility and associated educational, vocational, behavioral and additional life-skills space at the South Placer Jail, located in the Bill Santucci Justice Center, a County owned parcel in Roseville, CA.

**BE IT FURTHER RESOLVED** that the Board of Supervisors hereby:

- A. Appoints Lisa James, Capital Improvement Manager, as the County Construction Administrator; Valerie Bayne, Administrative Services Manager, as the Project Financial Officer; and Lieutenant Carol Walsh as Designated Project Contact Person and Coordinator.
- B. Approving the forms of the project documents deemed necessary, as identified by the State Public Works Board to the Board of State and Community Corrections, to effectuate the financing authorized by the legislation.
- C. Authorization of, Jennifer Montgomery, Chair of Board of Supervisors to sign the said application and submit the proposal for funding.
- D. Assures that the County will adhere to state requirements and terms of the agreements between the County, The Board of State and Community Corrections and The State Public Works Board in the expenditure of state financing and county match funds.
- E. Assures that the County has appropriated, and assures an adequate amount of available matching funds to satisfy the counties' contribution; the amount of match is identified by the County on the funding proposal forms submitted to the Board of State and Community Corrections; The identified matching funds are compatible with the states' lease revenue bond financing.
- F. Assures that the County will fully and safely staff and operate the facility that is being constructed (consistent with Title 15, California Code of Regulations. Chapter 1, Subchapter 6 section 1756 (j) (5), within ninety days after project completion.
- G. Assures that the County has project site control through fee simple ownership of the site, and right of access to the project sufficient to assure undisturbed use and possession of the site, and will not dispose of, modify the use of, or change the terms of the real property title, or other interest in the site of facility subject to construction, or lease the facility for operation to other entities, without permission and instructions from the Board of State and Community Corrections, for so long as the State Public Works Board lease-revenue bonds secured by the financed project remain outstanding; and,
- H. Attestation to \$387,000.00 as the current fair market land value for the proposed new or expanded facility, actual on-site land value has been documented from an independent appraisal by Bender Rosenthal of Sacramento.

Before the Board of Supervisors  
County of Placer, State of California

In the matter of:

A Resolution authorizing application to the Board of State and Community Corrections 2017 Jail Construction Financing Program, SB 844, in the amount of \$30 million to provide funding to assist with the construction of a 120-bed medium security facility and associated educational, vocational behavioral and life-skills treatment space.

Resolution No.: 2017-043

The following Resolution was duly passed by the Board of Supervisors of the County of Placer at a regular meeting held February 21, 2017, by the following vote on roll call:

Ayes: DURAN, WEYGANDT, HOLMES, UHLER, MONTGOMERY

Noes: NONE

Absent: NONE

THE FOREGOING INSTRUMENT IS A CORRECT  
COPY OF THE ORIGINAL ON FILE IN THIS OFFICE  
ATTEST

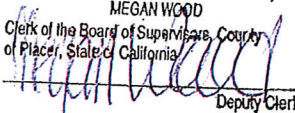
MEGAN WOOD  
Clerk of the Board of Supervisors, County  
of Placer, State of California  
  
Deputy Clerk

Signed and approved by me after its passage.

  
Chair, Board of Supervisors

Attest:

  
Clerk of said Board

---

**BE IT RESOLVED** by the Board of Supervisors of the County of Placer, State of California, that this Board hereby authorizes the Sheriff's Office to submit an application to the Board of State and Community Corrections 2017 Jail Construction Financing Program, SB 844, in the amount of \$30 million, to provide funding to assist with the construction of a 120-bed medium security facility and associated educational, vocational, behavioral and additional life-skills space at the South Placer Jail, located in the Bill Santucci Justice Center, a County owned parcel in Roseville, CA.

**BE IT FURTHER RESOLVED** that the Board of Supervisors hereby:

- A. Appoints Lisa James, Capital Improvement Manager, as the County Construction Administrator; Valerie Bayne, Administrative Services Manager, as the Project Financial Officer; and Lieutenant Carol Walsh as Designated Project Contact Person and Coordinator.
- B. Approving the forms of the project documents deemed necessary, as identified by the State Public Works Board to the Board of State and Community Corrections, to effectuate the financing authorized by the legislation.
- C. Authorization of, Jennifer Montgomery, Chair of Board of Supervisors to sign the said application and submit the proposal for funding.
- D. Assures that the County will adhere to state requirements and terms of the agreements between the County, The Board of State and Community Corrections and The State Public Works Board in the expenditure of state financing and county match funds.
- E. Assures that the County has appropriated, and assures an adequate amount of available matching funds to satisfy the counties' contribution; the amount of match is identified by the County on the funding proposal forms submitted to the Board of State and Community Corrections; The identified matching funds are compatible with the states' lease revenue bond financing.
- F. Assures that the County will fully and safely staff and operate the facility that is being constructed (consistent with Title 15, California Code of Regulations. Chapter 1, Subchapter 6 section 1756 (j) (5), within ninety days after project completion.
- G. Assures that the County has project site control through fee simple ownership of the site, and right of access to the project sufficient to assure undisturbed use and possession of the site, and will not dispose of, modify the use of, or change the terms of the real property title, or other interest in the site of facility subject to construction, or lease the facility for operation to other entities, without permission and instructions from the Board of State and Community Corrections, for so long as the State Public Works Board lease-revenue bonds secured by the financed project remain outstanding; and,
- H. Attestation to \$387,000.00 as the current fair market land value for the proposed new or expanded facility, actual on-site land value has been documented from an independent appraisal by Bender Rosenthal of Sacramento.

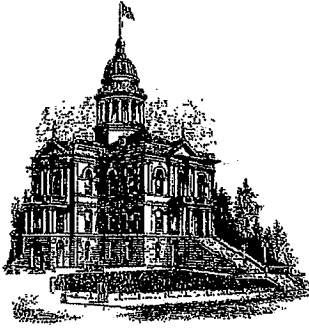

## PLACER COUNTY COUNSEL

GERALD O. GARDEN, COUNTY COUNSEL

175 Fulweiler Avenue  
Auburn, California 95603  
Telephone: (530) 889-4044  
Facsimile: (530) 889-4069  
[www.placer.ca.gov](http://www.placer.ca.gov)

February 15, 2017

Board of State and Community Corrections  
County Facilities Construction Program  
2590 Venture Oaks Way, Suite 200  
Sacramento, CA 95833

Attn: Oscar Villegas

Re: Senate Bill 844 – Adult Local Criminal Justice Facilities Construction  
Certification of CEQA Compliance Re: South Placer Justice Center

Mr. Villegas:

This letter shall certify that the above project is in compliance with the California Environmental Quality Act (CEQA).

The City of Roseville Planning Commission (“Planning Commission”), at its December 11, 2003 hearing, approved a Major Project Permit [Stages 1 and 2-MPP 03-02/03], Conditional Use Permit (CUP 03-05), and Tentative Subdivision Map for the construction of a 679,149 square foot justice services facility on the Project site. The Project approval included a 110,700 square foot Courthouse; 60,000 square foot private office building (Office B); 163,677 square foot justice services building (Office A – District Attorney, Probation etc.); 40,000 square foot archive/storage building; 50,889 square foot sheriff substation; 18,733 square foot ancillary building; and a 232,150 square foot detention facility with a capacity for up to 980 inmates (collectively, the “Project”). The Tentative Subdivision Map authorized the subdivision of the +/- 67 acre property, which included the Project site into four parcels.

The Project is to be developed in phases through the year 2025. Phase I of the Project included the initial construction of the South Placer Adult Correctional Facility. This included a 390 bed (270 medium/maximum security and 120 minimum security beds) facility which provided booking/intake/release, a vehicle sallyport, a 45 bed medical unit, correctional food service, laundry, warehouse storage and administration offices.

Phase II of the Project will incorporate the additional housing, associated programs, vocational training and mental health space. The project will consist of a separate medium security housing

Mr. Oscar Villegas  
Board of State and Community Corrections  
Certification of CEQA Compliance  
February 15, 2017  
Page 2

unit for a total of 120 beds. Each housing pod will contain a multipurpose room and a partially covered recreation yard to accommodate year round use, even in inclement weather.

In accordance with Section 21083 of the Public Resources Code and Section 15075 of the California Environmental Quality Act (CEQA) Guidelines, a Notice of Determination for a Mitigated Negative Declaration for the project was recorded and posted on February 27, 2004 by the County Clerk of Placer County. [See attached copy.]

The Placer County Counsel's Office hereby certifies that the associated statute of limitations to challenge the CEQA determination on the Project have expired and no challenges were filed.

Very truly yours,

PLACER COUNTY COUNSEL'S OFFICE

By: \_\_\_\_\_

  
Robert K. Sandman  
Deputy County Counsel

RKS/\_\_\_\_

Enclosure



**PLACER COUNTY FACILITY SERVICES DEPARTMENT**

11476 C Avenue, Auburn, CA 95603 (530) 886-4900/FAX (530) 889-6863

**NOTICE OF DETERMINATION**

**FILED**

**PROJECT INFORMATION FEB 27 2004**

**TITLE OF PROJECT:** South Placer Justice Center

**LEAD AGENCY:** Placer County Department of Facility Services  
11476 C Avenue  
Auburn, CA 95603

**CONTACT PERSON:** Dennis Salter, Project Manager  
(530) 886-4900

**PROJECT LOCATION:** The project site comprises approximately 74 acres located at 10800 Industrial Avenue, in the northwest portion of the City of Roseville.

**APPLICANT:** Placer County Facility Services  
11476 C Avenue  
Auburn, CA 95603

**PROJECT DESCRIPTION:** Construction of a 676,149 square foot (sq ft) justice facility on ±55 acres of the ±74-acre project site. The proposed Justice Center would include a 110,700 sq. ft. courthouse, 60,000 sq. ft. private office building (Office B), 163,677 sq ft justice services building (District Attorney, Public Defender, etc.), 40,000 sq ft archive/storage building, 50,889 sq ft sheriff substation, 18,733 sq ft ancillary building (vehicle shop), and a 232,150 sq ft detention facility with a capacity for up to 980 inmates. The project will be developed in phases through the year 2025. The City of Roseville will preserve 19 acres of wetlands associated with Pleasant Grove Creek.

**STATE CLEARINGHOUSE NUMBER:** N/A, Not submitted to State Clearinghouse

Jim McCauley  
COUNTY CLERK OF PLACER COUNTY  
BY Alanna  
DEPUTY

POSTED FEB 27 2004  
rough  
JIM McCAULEY, COUNTY CLERK  
y Alanna  
Deputy Clerk

*In accordance with Section 21083 of the Public Resources Code, this document provides a Notice of Determination as made by the Placer County Board of Supervisors for the proposed project. This document is submitted to the Placer County Clerk, at 2954 Richardson Drive; Auburn with the request that the Clerk post this notice pursuant to Section 15075 of the CEQA Guidelines.*

This NOTICE OF DETERMINATION is to advise that the Placer County Board of Supervisors has approved the project described above on February 24, 2004, and has made the following determinations:

1. The project will not have a significant effect on the environment following Implementation of mitigation measures.
2. A Mitigated Negative Declaration was prepared for this project pursuant to the provisions of CEQA.
3. Mitigation measures were made a condition of the approval of the project.
4. A statement of Overriding Considerations was not adopted for this project.
5. Certification: (*de minimus* impact finding) The public agency has made a finding that the project will not individually or cumulatively have effect on wildlife resources, as defined in Section 711.2 of the Fish and Game Code. A \$30.00 Posting fee is hereby transmitted to the County Clerk.

This is to certify that the Mitigated Negative Declaration and record of project approval are available to the General Public at the Placer County Department of Facility Services, located at 11476 C Avenue in DeWitt Center.

Thomas Miller  
Thomas Miller  
Director, Placer County Department of Facility Services

2/26/04  
Date

#2066

**DRAFT PRELIMINARY Placer County SB844 Submission Space Program Summary**

Component/ Space ID/ Name	Rated Beds	CGSF	Comments
<b>SITE DEVELOPMENT</b>			
00. Site Preparation			
00. Parking		14,100	paved parking area
subtotal		14,100	exterior space, not counted as building area

<b>NORTH SIDE EXPANSION</b>			
<b>Non-Housing Areas</b>			
01 Zone Administration Area		1,269	inside vs. outside security
02 Security/Control and Visitation		3,108	includes security access control.
03 Program Services		14,386	
a. Staff Area		2,590	central functions, balance in Direct Housing Support
b. Education/Training Venues		11,796	
04 Support Services		484	includes supplemental central plant
subtotal		19,247	
<b>Housing Areas</b>			
05 Female Minimum Security	60	9,555	One 60-Bed Multiple Occupancy
06 Mens Re-Entry Housing Unit	60	9,555	One 60-Bed Multiple Occupancy
subtotal		120	19,110
<b>TOTAL - New Construction</b>		<b>38,357 Total CGSF</b>	
Building Gross Factor		1.15	
<b>Total Project Building Area</b>		<b>44,111 Total BGSF</b>	



**WATER MASTER PLAN**

REGISTERED PROFESSIONAL ENGINEER  
MARK J. SMITH  
NO. 45843  
CALIFORNIA  
REGISTERED PROFESSIONAL ENGINEER  
MARK J. SMITH  
NO. 45843  
CALIFORNIA

**MAKAY & SOMPS**  
11801 60<sup>TH</sup> PARK BROSKE ROAD  
SOUTH PLACER, CALIFORNIA 95670  
TEL: (916) 438-1100  
WWW.MAKAYANDSOMPS.COM

DESIGNED BY: M. SMITH  
CHECKED BY: M. SMITH  
DRAWN BY: M. SMITH  
SCALE: 1"=60'  
DATE: MAY 2010

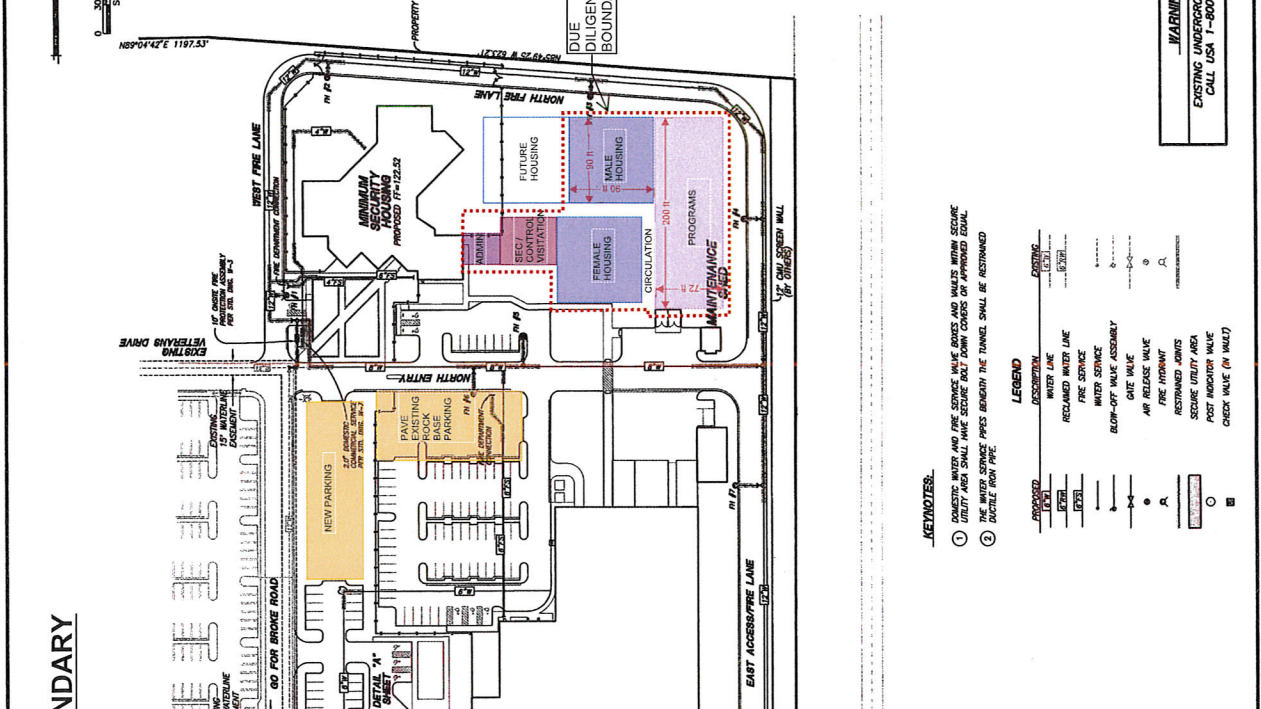

**KEYNOTES:**

- EXISTING WATER AND FIRE SERVICES HAVE BARRIERS AND VALVES WITHIN SERVICE UTILITY AREAS SHALL HAVE SECURE DUCT, DOWN COVERS OR APPROVED EQUAL.
- THE WATER SERVICE PIPES AROUND THE TUNNEL SHALL BE RESTRAINED DUCTILE IRON PIPE.

**LEGEND**

SYMBOL	DESCRIPTION
(Symbol)	EXISTING WATER LINE
(Symbol)	RECLAIMED WATER LINE
(Symbol)	FIRE SERVICE
(Symbol)	WATER SERVICE
(Symbol)	SLOP-OFF WATER ASSEMBLY
(Symbol)	GATE VALVE
(Symbol)	AIR RELEASE VALVE
(Symbol)	RESTRAINED JOINTS
(Symbol)	SECURE UTILITY AREA
(Symbol)	POST INDICATOR VALVE
(Symbol)	CHECK VALVE (ON WAULT)

**DETAIL 'A' NOTES:**

- PLACE NEW 17" I.D. TEE. PLACE 17" I.D. REDUCER WITH 6" GATE VALVE AT REDUCER TO SOME SERVICE MANHOLE.
- REMOVE ALL EXISTING WATER FACILITIES BEYOND NEW TEE.
- FIRE HYDRANT ASSEMBLY, FULLY RESTRAINED.
- WATER MANHOLE TO BE FULLY RESTRAINED DUCTILE IRON PIPE FROM TEE TO SERVICES.
- INSTALL 3" DOMESTIC COMMERCIAL SERVICE PER CITY OF ROSSVILLE STANDARD DRAWING M-4.
- INSTALL 1.5" COMMERCIAL IRRIGATION SERVICE PER CITY OF ROSSVILLE STANDARD DRAWING M-8. EXISTING 1.5" IRRIGATION SERVICE TO BE MOVED TO NEW MAIN FOR SERVICE CONNECTION.
- A 1.5" IRRIGATION SERVICE SHALL BE MOVED TO NEW MAIN FOR SERVICE CONNECTION.
- DOMESTIC WATER PIPE INCREASES TO 6" DIAMETER BEYOND R.P. MANHOLE DEVICE ON 3" DOMESTIC SERVICE.
- POINT OF CONNECTION FOR SOUTH PLACER ADULT CORRECTIONAL FACILITY LANDSCAPE IRRIGATION.
- RECONNECT RELOCATED IRRIGATION SERVICE OUTFALL PIPE TO EXISTING IRRIGATION PAVING.
- 6" GATE VALVE
- 6" GATE VALVE
- 8" IRR. RND
- 8" IRR. RND

NOTE: ALL MATERIALS TO BE USED IN CONSTRUCTION OF MANHOLE SERVICES, AND FIRE HYDRANT ASSEMBLY SHALL BE NEW. EXISTING MATERIAL MAY ONLY BE USED AT THE DISCRETION OF THE ELD INSPECTOR.

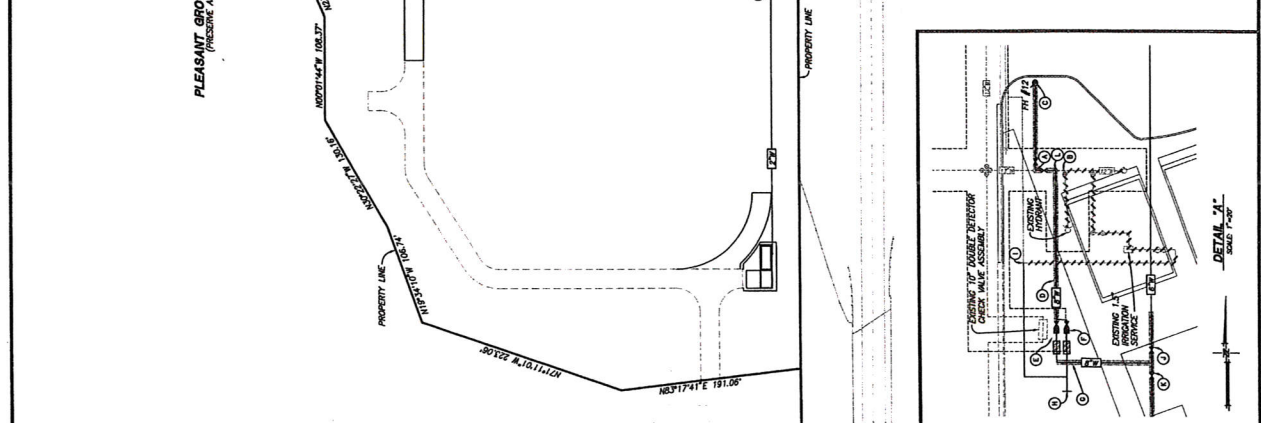

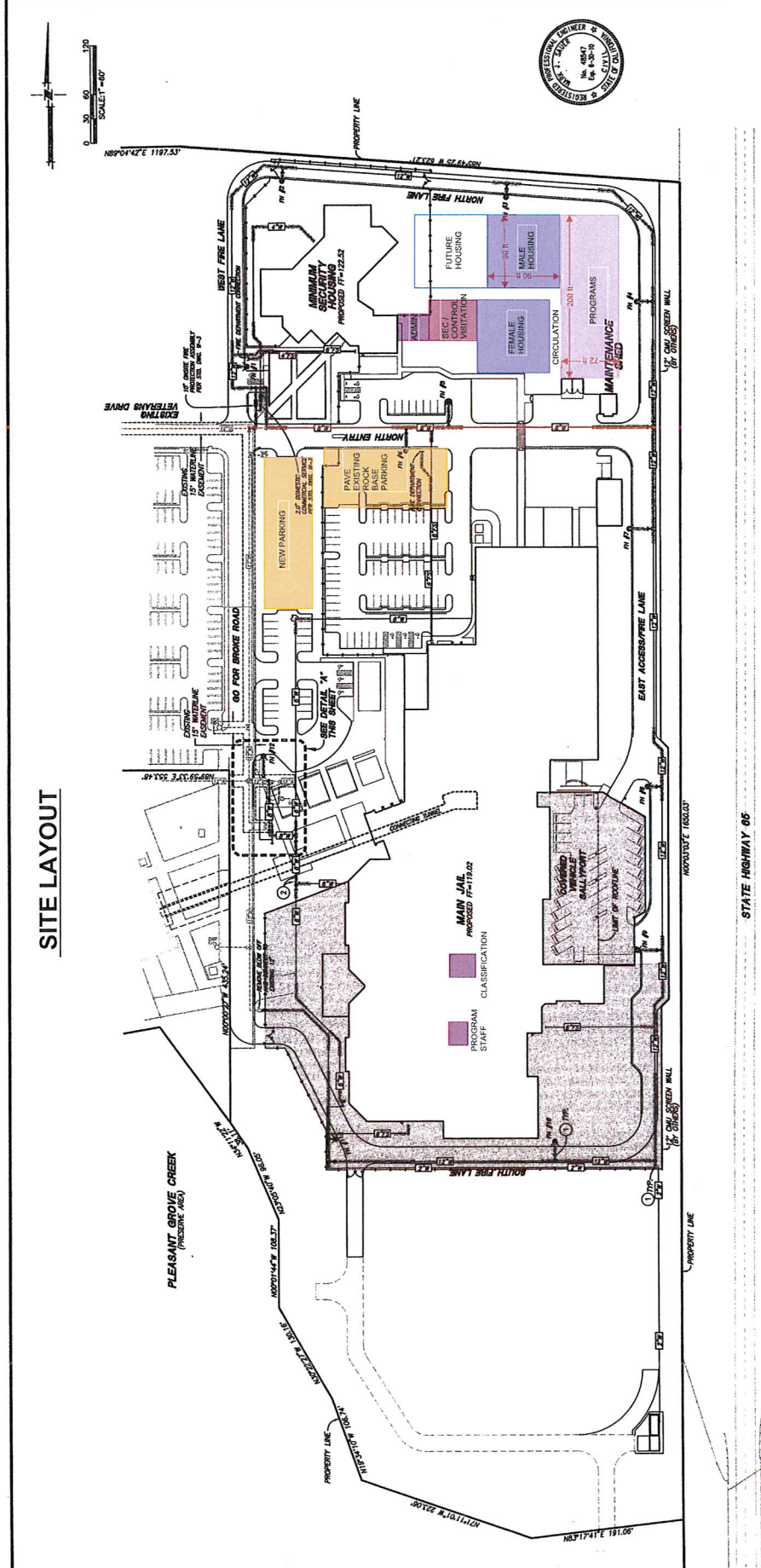

**KEYNOTES:**

- DOMESTIC WATER AND FIRE SERVICE VALVE BOXES AND WALLETS WITHIN SECURE UTILITY AREA SHALL HAVE SECURE LOCK DOWN COVERS OR APPROVED EQUAL.
- DUCTILE IRON PIPE BENEATH THE TUNNEL SHALL BE RESTRAINED.

**DETAIL 'A' NOTES:**

- PLACE NEW 12" TEE, PLACE 12" OF REDUCER WITH 6" GATE VALVE AT REDUCER TO SERVICING MANHOLE.
- REMOVE ALL EXISTING WATER FACILITIES BEYOND NEW TEE.
- FIRE INSTANT ASSEMBLY FULLY RESTRAINED.
- WATER MANHOLE TO BE FULLY RESTRAINED DUCTILE IRON PIPE FROM TEE TO SERVICES.
- INSTALL 3" DOMESTIC COMMERCIAL SERVICE PER CITY OF ROSSELLE STANDARD DRAWING M-8.
- INSTALL 1/2" DOMESTIC BRONZE SERVICE PER CITY OF ROSSELLE STANDARD DRAWING M-8.
- EXISTING WATER TO BE TAKEN FROM EXISTING SERVICE TO NEW SERVICE BY CITY FORCES ON A TIE AND INSTALLED BASED TO BE PAID FOR BY THE CONTRACTOR.
- DOMESTIC WATER PIPE INCREASES TO 6" DIAMETER BEYOND R.P.P. BACKFLOW DEVICE ON 3" DOMESTIC SERVICE.
- POINT OF CONNECTION FOR SOUTH PLACER ADULT CORRECTIONAL FACILITY LANDSCAPE IRRIGATION.
- RECONNECT RELOCATED IRRIGATION SERVICE OUTCALL PIPE TO EXISTING IRRIGATION PIPING.
- 6" GATE VALVE.
- 6" GATE VALVE.
- APP. BEND.
- APP. BEND.

NOTE: ALL MATERIALS TO BE USED IN CONSTRUCTION OF MANHOLE SERVICES, AND FIRE INSTANT ASSEMBLY SHALL BE NEW. EXISTING MATERIAL MAY ONLY BE USED AT THE DISCRETION OF THE E.I.M. INSPECTOR.

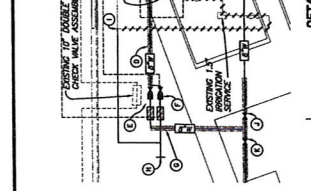

PROCESS	DESCRIPTION	EXISTING
LEVEL	WATER LINE	.....
LEVEL	RECLAIMED WATER LINE	.....
LEVEL	FIRE SERVICE	.....
LEVEL	WATER SERVICE	.....
LEVEL	BLOW-OFF WATER ASSEMBLY	.....
LEVEL	GATE VALVE	.....
LEVEL	APP. INSTANT ASSEMBLY	.....
LEVEL	RESTRAINED JOINTS	.....
LEVEL	SECURE UTILITY AREA	.....
LEVEL	POST INDICATOR VALVE	.....
LEVEL	CHECK VALVE (IN WALL)	.....

**WARNING:**  
EXISTING UNDERGROUND UTILITIES  
CALL USA 1-800-227-2600

**SITE LAYOUT**



11/14/2018 08:42:28 AM  
 [1] In:\2018\18409\18409-01\18409-01.dwg [2] In:\2018\18409\18409-01\18409-01.dwg  
 11/14/2018 08:42:28 AM  
 [1] In:\2018\18409\18409-01\18409-01.dwg [2] In:\2018\18409\18409-01\18409-01.dwg



# COUNTY OF PLACER

## Jail Needs Assessment Update

DLR Group Project Number: 75-15129-00

August 14, 2015



1050 20<sup>th</sup> Street, Suite 250  
Sacramento, CA 95811

Table of Contents  
County of Placer Jail Needs Assessment

<b>Section</b>	<b>Page</b>
Introduction, Acknowledgement and Executive Summary	
1.0    Needs Assessment Process	1
2.0    Participants and Acknowledgements	1
3.0    Executive Summary	2
4.0    Previous Studies and Reports	6
A    Elements of the System	7
B    Operational and Design Philosophy	15
C    Current Inmate Population	19
D    Classification of Inmates	26
E    Programs	33
F    Analysis of Adult Detention Trends	39
G    Adequacy of Staffing Levels	49
H    Ability to provide Visual Supervision	53
I    Adequacy of Record keeping	55
J    Compliance with Standards	57
K    Unresolved Issues	58
L    Recommendations	59

# Introduction, Acknowledgment and Executive Summary

## 1.0 Needs Assessment Process

Placer County has contracted with DLR Group to assist the County and Sheriff's offices in developing an updated needs assessment to supplement the 2012 needs assessment update. Placer County and DLR Group have been meeting, collecting data and developing this needs assessment update over the course of June and July 2015 specifically in response to SB 863.

## 2.0 Participants and Acknowledgments

The preparation of this needs assessment would not have been possible without the assistance of a number of professionals from Placer County. While the following list by no means represents all of the people who participated in this effort, it is our attempt to recognize the primary contributors who helped make this planning effort a success. The efforts and participation of the following individuals are gratefully acknowledged.

### **Placer County Board of Supervisors**

District 1- Jack Duran, Representing Roseville

District 2- Robert Weygandt, Vice Chair, Representing Lincoln, Sheridan and portions of Rocklin

District 3- Jim Holmes, representing North Auburn, Ophir, Newcastle, Penryn, Loomis and most of Rocklin

District 4- Kirk Uhler, Chair, Representing Granite bay and portions of Roseville

District 5- Jennifer Montgomery, Representing the communities from Auburn to North Lake Tahoe

### **Placer County Sheriff's Office**

Edward N. Bonner, Sheriff-Coroner-Marshal

Devon Bell, Under Sheriff

Don Hutchinson, Captain Corrections Commander

Carol Walsh, Lieutenant Corrections

Rebecca Lyke, Sergeant and Programs Director

James Corry, Classification Officer

Dorothy Arredondo, Support Officer

Jake Mucher, Facilities Director

Erik Carlson, Technology Specialist II

David Powers, Lieutenant Corrections

### **South Placer County Jail Facility**

The South County Jail was recently built and is currently being staffed and activated. The facility is designed for a rated bed capacity of 420. The facility is a standalone Jail with all support and services provided. The facility was planned to allow future expansions to accommodate future changes in inmate populations and needs within the criminal justice system. A future Arraignment Court facility is planned to be attached to the Jail, primarily to conduct initial court appearances.

Program Space: Adequate programs and vocations rooms are not available for all activities. Currently, the basic programs such as adult education, religious services, counseling, AA and NA classes, mental health evaluations and classes along with other programs to reduce recidivism all have to share the five rooms provided. With scheduling conflicts to utilize the five rooms available coupled with classification and separations issues for all programs, inmate's ability to participate in programs are diminished.

### **B. Operational and Design Philosophy**

The Sheriff's Office operational and design philosophy is to provide facilities which are efficient for staff and inmate security and safety. The podular designed facilities provide for both direct and indirect visual supervision of the inmates. The philosophy is to bring all services to the housing units decreasing the need for inmate movement.

Desired Operational and Design Philosophy in a New Facility: The Sheriff's Office advises that the proposed facilities will incorporate the qualities of design and movement into the new facility, including unescorted movement, podular design, direct supervision, and ample program space.

### **C. Current Inmate Population**

The jail inmate population was reviewed, as well as current statistical information reports to provide a clear picture of the Placer County Jail inmate population, this complete study is described in Section F.

### **D. Classification of Inmates**

The classification system at Placer is solid, with well trained and supervised full time correctional staff. The classification system utilizes the NIC/NIJ objective classification system and provides adequate housing options to properly separate the various classifications.

### **E. Programs**

All Title 15 program requirements are being met. Additional educational and rehabilitation programs are offered including a computer training room providing literacy training. Unfortunately, the program space is only sufficient to do basic programs. The Sheriff and his staff are very supportive of inmate programs and clearly there is a shared philosophy that providing inmates with both required and voluntary rehabilitation and self-help programs are supported by County departments and officials. It is hoped the proposed SB 863 funding can provide the comprehensive program space the County hopes to provide to better reduce recidivism.

### **Placer County's Current and Future Bed Needs**

Placer County plans to close the current outdated housing units that are used for the medium and minimum security inmates in the Auburn Jail Facility. Inmates from these closed units will be placed into the South Placer Jail. The replacement beds will be built in South Placer Jail for specific housing needs of Mental Health and inmates that are to re-enter society. The net beds are actually a slight reduction based on providing the much needed specific housing when outdated medium and minimum security facilities in Auburn are closed.

### **G. Adequacy of Staffing Levels**

**Current Staffing Levels:** The Jail Commander advised that the staffing issues are being addressed by filling vacancies that have been a problem in the past. The goal for staffing is to maintain the existing staffing while shifting inmates from the existing Auburn facility to the new more efficient and secure South Placer Jail Facility.

**Staffing for the new Proposed Facilities:** Discussions were held with Sheriff's managers regarding the staffing of the new housing units. The desired and planned staffing for the new housing units and related spaces will be a combination of direct, indirect and rover supervision. The minimum security housing unit will have a direct supervision housing officer in each of the two pods and a control room officer with direct visual into both pods. A rover officer will supervise movement, provide daytime staff breaks and provide intermittent supervision of the program areas.

### **H. Ability to provide Visual Supervision**

All of Placer's facilities offer excellent design and philosophy of supervision while providing visual supervision of the inmates. The design of the facilities are all podular with direct visual of the day rooms and celled areas from either a glass control room or both a glass control room and direct supervision officers stationed in the pods. The proposed South Placer Jail housing will provide outstanding visual supervision which includes a podular design with glass front double cells and direct supervision officers on a raised control room observing from above.

### **I. Adequacy of Record Keeping**

The Placer County Corrections system demonstrated excellent records-keeping in the part of their Administrative Legal Clerks and associated staff and other areas. The grievance system is excellent and provides software to track and study grievance complaints by type and outcome. The inmate hard booking files are neat and well organized. While not as user friendly for obtaining all statistical reports as the Sheriff's Office would desire, the Corrections Management System [CMS] is adequate and provides many reports. The system provides ready access to incident and inmate disciplinary reports and offers adequate classification and medical data bases. The system also alerts staff to certain inmate dangers.

### **J. Compliance with Standards**

The Needs Assessment update team reviewed inspections related to the Placer County Jail. Review of the history of the various inspection reports indicates very positive findings and comments.

## A. Elements of the System

The Placer County Sheriff's Office operates two Type II Adult Detention Facilities located in Auburn and Roseville, California. The facilities are used for the detention of males and females pending arraignment, during trial and upon a sentence of commitment. The Auburn facility is outdated, staff intensive and in need of program space. Shifting the inmate capacity to South Placer Jail will provide much needed programs for a greater inmate population and increase staff efficiencies and security.

### A1 Existing Jail Elements (Auburn County Jail Facility)

The Placer County Auburn Jail was originally built in 1985 with additions in 1992 and 2002. Originally the facility contained 100 beds and now has a rated bed capacity of 492 (Refer to Table A.1). Over the years, there have been several additions, expansions, renovations and repurposing of spaces to accommodate the growth and needs of the County. A few of those additions were the addition of housing units, visitation, kitchen and the repurposing for laundry and property storage as well as many other modifications needed to maintain safe operations.

**Single Occupancy Cells:** Single occupant cells provide for maximum security disciplinary segregation, administrative segregation and protective custody inmates and need to be available for proper facility management. When confinement exceeds 10 hours per day, 80 square feet of space is required. There are currently 52 cells available as single occupancy cells.

An adequate number of ADA cells need to be provided (current cells should be reviewed to determine ADA compliance). All cells are "wet" cells with stainless steel combination fixtures. A bed and a desk are provided in cells where appropriate.

**Double Occupancy Cells:** Double occupancy cells are provided for general population and medium security inmates. There are 208 beds currently available as double occupancy cells.

**Dormitories:** Dormitories for housing minimum security inmates are provided as well as AB 109 inmates. ADA dormitory beds, seating and plumbing fixtures are provided. Showers are provided at a minimum ratio of one shower for every 12 inmates. There are currently 212 beds available for dormitory occupancy.

**Dayrooms:** Dayrooms are provided for all pods (tanks) and contain tables and seating to accommodate the maximum number of inmates allowed access to the dayroom at any given time in each housing unit. Access is provided for toilets, washbasins, drinking fountains and showers from the dayroom. Dining will occur in the dayroom of each housing unit. ADA accommodations need to be provided as necessary.

**Showers:** Inmates have access to showers at a minimum ratio of one shower for every 12 inmates (with some BSCC exceptions in specific areas). In most cases an inmate requiring an ADA accessible shower is escorted to the intake booking area where they can be adequately accommodated.



advanced care, which cannot be provided at Placer County Jail are provided outside of the facility. A staff area should be provided for mental health professionals to evaluate inmates and provide mental health programs as necessary. Currently, the mental health staff and medical staff all share the medical clinic. Interview rooms and mental health program space needs to be provided for this purpose. There aren't any suicide prevention / observation cells in the medical unit as these are held in the intake booking area. Mental health staff supports are mobile for the Auburn Jail from offsite and do not have any office space here.

**Outdoor Exercise:** There is currently four inmate recreation spaces shared by all classifications of inmates housed in seventeen pods (tanks). The recreation areas are enclosed with secure walls and a secure mesh enclosure above. There isn't a solid roof covered area for inclement weather use. The exercise area is monitored by the CCTV systems and the control tower via direct visions of some of the areas.

**Housing/Central Control:** The central control room monitors and operates all security perimeter penetrations and primary circulation in the facility. Additionally, Auburns Central Control has limited overriding capabilities of the housing units. It cannot completely take control of the housing unit like the South Placer Jail. Central control has visual supervision of the main corridor. No escape hatch has been provided to allow an officer in central control to exit to the roof in the event of a natural disaster or disturbance.

**Staff Facilities:** Male and female toilet facilities and locker rooms are provided. Training and conference spaces are limited.

**Food Service:** The current kitchen was added in 1993 and has now been converted to a preparation kitchen with main food production provided by the South Placer Jails central production kitchen. The current kitchen is within the secure perimeter and staffed by a commercial food service provider. Inmates will be fed in the dayrooms of their respective housing pods. Sack lunches are provided for inmates who are away from the facility for the day (e.g., on work crews and inmates likely to be in court for the day).

**Laundry:** Currently, no laundry facilities are located at the Auburn County Jail. The laundry needs are currently being accommodated at the South Placer County facility with soiled and clean laundry being transported by staff between the two facilities. This process has many security and staffing concerns and needs to be addressed. The current plan is to modify some existing kitchen space for onsite laundry facilities will solve the concerns of transporting laundry between facilities.

**Maintenance Space:** Maintenance work and storage areas are not provided at this facility. The current plan is to modify some existing kitchen space for onsite facilities. This will greatly improve response for maintenance and facility management issues.

**Warehouse Storage:** Warehouse storage space is not provided at this facility. Institutional storage needs to be provided as necessary to accommodate the rated bed capacity. Storage in this building does not meet BSCC requirements nor is there adequate space. Inmate property storage is located in the current intake booking area and undersized. Storage space isn't currently available for mattresses, additional clothing and other jail supplies. 5,000 square foot of offsite warehouse space is assigned to the Auburn jail.

**Perimeter Security:** Walls of the facility are the primary maximum-security perimeter for this type II Jail.

## A2 Existing Jail Elements (South Placer County Jail Facility)

The South County Jail was recently built and is currently being staffed and activated. The facility is designed for a rated bed capacity of 420 (Refer to Table A.2). The facility is a standalone Jail with all support and services provided as well as being planned to allow future expansions to accommodate future changes in inmate populations and needs within the criminal justice system. A future courts facility is planned to be attached to the Jail, primarily to conduct initial court appearances.

**Single Occupancy Cells:** Single occupant cells provide for maximum security disciplinary segregation, administrative segregation and protective custody inmates and need to be available for proper Jail management. When confinement exceeds 10 hours per day, 80 square feet of space is required. There aren't currently any cells available as single occupancy cells.

An adequate number of ADA cells are provided. All cells are "wet" cells with stainless steel combination fixtures. A bed and a desk are provided in cells where appropriate.

**Double Occupancy Cells:** Double occupancy cells are provided for general population, medium security and administrative segregation inmates. There are 300 beds currently available for double occupancy cells.

**Dormitories:** Dormitories for housing minimum security inmates are provided including ADA dormitory beds, seating and plumbing fixtures. Showers are provided at a minimum ratio of one shower for every 12 inmates. There are currently 120 beds available for dormitory occupancy.

**Dayrooms:** Dayrooms are provided for all pods and contain tables and seating to accommodate the maximum of inmates allowed access to the dayroom at any given time in each housing unit. Access is provided for toilets, washbasins, drinking fountains and showers from the dayroom. Dining will occur in the dayroom of each housing unit. ADA accommodations are provided as necessary.

**Showers:** Inmates have access to showers at a minimum ratio of one shower for every 12 inmates. ADA accommodations are provided as necessary.

**Intake/Release/Processing:** Intake, release and processing occur in intake/release/processing areas. Holding cells, safety cells, sobering cells, open waiting, showers for inmates, toilet facilities for staff and inmates, processing area, administrative office area and interview spaces are provided. Space for inmate property storage and clothing storage is available. A weapons locker is provided in the vehicular sally port. A separate area is used for all transports to court, CDCR, other facilities, etc. This separate transport area greatly assists in not disrupting the flow of inmates thru the intake booking and release processes. In general, this facility will meet the needs of the County for many years to come. The long term intent is that when this South Placer County Jail facility is fully on line, about 70% of all bookings will be processed at the South Placer Jail and thus the Auburn Jail will become a booking and short term holding facility for the local community and law enforcement. A good sized vehicle sally port is provided to accommodate all the future needs of this facility.

**Initial Appearance Courts:** There is a shell built court facility that is attached to the South Placer Jail with access to the public. The long term plan is that once the South Placer Jail and Courts facilities are fully on line that all Initial Appearance Court proceedings will be held there.

**Maintenance Space:** Adequate maintenance space is provided for workshops and storage of supplies and parts.

**Warehouse Storage:** Adequate warehouse storage facilities are available for dry goods and inmate clothing storage.

**Perimeter Security:** The walls of the facility are the primary maximum-security perimeter for this Type II Jail.

**Table A.2  
Placer County Jail, South Placer Existing Bed Capacity & BSCC rated bed capacity**

Placer County, South Placer Jail Existing Bed Capacity											
Housing Unit / Pod Tank	Gender	Classification	Current Cell Beds				Dormitory Beds		Total Beds / Unit	Current Capacity	
			# of Cells	Singl e	Double	Triple	# of Dorms	Beds			
1	A	N/A	N/A	30	0	60	0	0	0	60	60
	B	N/A	N/A	30	0	60	0	0	0	60	60
2	C	M	Ad. Seg.	15	0	30	0	0	0	30	30
	D	M	PCUS	15	0	30	0	0	0	30	30
	E	M	Max.	15	0	30	0	0	0	30	30
	F	M	SNO	15	0	30	0	0	0	30	30
3	G	F	Min.	30	0	60	0	0	0	60	60
	MS1	M	Min.	0	0	0	0	1	60	60	60
	MS2	M	Min.	0	0	0	0	1	60	60	60
<b>Totals</b>				150	0	300	0	2	120	420	420

**A3 Facilities Infrastructure Needs**

The existing Auburn Jail facility was constructed as a new facility in 1985 with an original rated bed capacity of 100 beds. At that time, the facility met the requirement of the BSCC and local buildings codes and standards. The facility was expanded in 1992 and again in 2002 to provide the current rated bed capacity of 492

The existing South Placer Jail facility was constructed as a new facility in 2014. The support infrastructure for this facility was designed for a site capacity of 980 inmates with an original rated bed capacity of 420 beds. At that time, the facility met the requirements of the BSCC and local buildings codes and standards. The facility is currently being activated and is not at full capacity.

## B. Operational and Design Philosophy

**Introduction:** The Policy, Goals and Objectives of Placer County Corrections Division are to maintain the constitutional, secure and humane detention of all arrested persons as prescribed by law. Policies are described in the Placer County Corrections Policy Manual.

The Corrections Division will be operated in conformance with State and National Jail Standards, State and Federal Laws, the Rulings of the State and Federal Courts, as well as the Placer County Sheriff's Department Policy and Procedure Manual.

### B1 Mission Statement:

The mission of the Placer County Sheriff's Office is to maintain the quality of life we enjoy and to ensure our County is a safe place to live, work and visit.

This will be accomplished through safeguarding individual liberties, building community partnerships, preventing crime and resolving those crimes that do occur.

We are also responsible for the professional care and custody of those confined within our jail facilities. Other duties include those of Marshal, security of the Courts, and efficient investigation of Coroner cases.

We are committed to this mission and conduct our responsibilities toward a goal of excellence and with dedication to the community we serve.

The primary function of the Corrections Division is to safely and securely detain both pre-trial detainees and County sentenced inmates. However, staff members understand that inmates are subject to deprivations resulting merely from confinement and that their role is not to inflict punishment, but make the inmate's period of confinement as productive as possible.

Most of Placer County Jail facility inmates are sentenced and AB 109 inmates. Staff members encourage each inmate to take advantage of opportunities provided for educational, health and personal self-improvements. In this way, staff members contribute to making inmate's return to the community as a positive and productive as possible. This goal can be realized only through the concerted efforts of all the staff members.

The effective operation of the Detention Center is dependent on highly motivated, well trained staffs, who continually strive to improve both their individual job performances and areas of responsibility. To encourage professional growth, staff members are provided with training within the department and are given opportunities to attend outside training.

**Professionalism**

We value the ideals and ethics of the law enforcement profession. We seek to maintain a clear sense of commitment, perspective, and direction. We strive to create an atmosphere that promotes teamwork, innovation, and continuing self-evaluation. Recognizing that the corrections environment presents us daily with an unrealistic view of the public and society as a whole, we will strive to maintain our respect for the individual worth, dignity, rights, and cultural diversity of all those in our custody, realizing that the vagaries of fate could place any of us in a similarly unfortunate position. We will maintain discipline within the institution in a fair, humane manner, striving always to resolve problem situations without recourse to physical force. When force is required, we will employ the minimum level necessary to maintain security and employee safety. We will try at all times to keep in mind that our task is not to judge or to punish-these are functions of the judicial system-but to safeguard the custody of offenders in a manner consistent with the preservation of human dignity and public safety.

**Employees**

We value our coworkers as our most important organizational asset. We realize our success depends on mutual respect, cooperation, and support. All employees will receive fair and equitable treatment, and be provided the proper tools and training to meet organizational goals and objectives. Since employee safety is of paramount importance in this institution, the security of the facility will be maintained at all times in the most stringent manner.

**B4 Goals and Objectives**

Goals and objectives of this needs assessment report is to understand the current conditions of the facilities and plan for the future growth to accommodate the ever changing needs of Placer County and the State of California. In addition, develop a phased development approach that is flexible to meet the ever changing needs of the State and the detention inmate requirements.

**B5 Facility Design Philosophy**

The philosophy of the Placer County Sheriff's Office is to utilize direct supervision in lower classification housing pods with a combination of direct supervision and a "guardian angel" control station watching the inmates while using direct supervision officers from a control room in general population, medium and-maximum units and indirect-direct visual through glass in maximum security. Rovers are used in maximum security and to supplement in other areas of the facilities. Officers are taught to use direct supervision communication skills in all units, not just in direct supervision units. Quality and frequent communication by staff is required.

The philosophy of supervision, quality of the facility design sight lines, communications prerequisites and training should help meet the requirements of the Prison Rape Elimination Act (PREA) and AB 109.

## C. Current Inmate Population

**Introduction:** The existing Placer County Jail lacks adequate space and staff to conduct the meaningful programs to reduce recidivism. Additionally, the lack of sufficient beds of the right environment and security for Mental Health treatment and Re-Entry creates problems in providing the much needed Therapeutic programs to treat the mentally ill and prepare the inmates scheduled for release for re-entry into the community.

### C1 Current Inmate Population:

**Special Inmate Populations:** Special inmate populations that need to be accommodated in the adult detention facilities include:

- Female inmates; including those who are pregnant or who are parents.
- Inmates with mental health needs.
- Inmates with medical and psychological needs including:
  - Developmentally disabled inmates.
  - Persons with communicable disease.
  - Adults with drug and alcohol problems.
  - Geriatric inmates.
  - Sexual offenders.
  - Suicide risks.
- Inmates with needs that fall under the Americans with Disabilities Act (ADA).
- Informants.
- Those with gang affiliations.
- High escape risks.
- Violent offenders.

**Females:** There is a need for female housing units. Females will be accommodated in separate housing and supervised by female correctional staff or by male correctional officers accompanied by female correctional staff. Additional issues include prenatal care for females who are pregnant, as well as the need to provide OB/GYN services for female inmates who might give birth while incarcerated.

**Mental Health:** The Placer County Jail currently offers limited mental health services. Housing units dedicated to inmates with mental health issues are needed. Space and facilities needed to accommodate:

- Housing units for the mentally impaired.
- Mental health programs including education.
- Mental health interview, assessment and diagnosis activities.
- Pharmaceutical, medical supplies and records storage related to the needs of inmates with mental health issues
- Spaces or mental health counseling and treatment.
- Designed to reduce stress and promote good mental health.

**Disabled Accessibility:** Individual needs covered under California Accessibility Code and Americans with Disabilities Act (ADA) sets accessibility guidelines for public places to accommodate individuals with disabilities. These guidelines must be applied during design, construction and alteration of such buildings and facilities to the extent required by regulations issued by federal agencies, including the Department of Justice.

**Areas covered by these guidelines include:**

- Space allowance and reach ranges
- Accessible routes
- Protruding objects
- Ground and floor surfaces
- Parking and passenger loading zones
- Curb ramps
- Ramps
- Elevators
- Platform lifts (wheelchair lifts)
- Windows
- Doors
- Entrances
- Drinking fountains and water coolers
- Water closets
- Toilet stalls
- Urinals
- Lavatories and mirrors
- Showers
- Toilet rooms
- Bathrooms, bathing facilities (including bathtubs) and shower rooms.
- Sinks
- Storage
- Handrails, grab bars, tub and shower seats.
- Controls and operating mechanisms
- Alarms
- Detectable warnings
- Signage
- Telephones
- Fixed or built-in eating and tables
- Assembly areas

**Informants:** Law enforcement informants often are the target of harassment and abusive behavior by other inmates if their status becomes known or is suspected. Housing that is separate from the general population is critical to ensure the protection and safety of informants.

**Gang Affiliation:** Persons in custody that are entering the facility are interviewed for gang affiliations. The admitting law enforcement agencies also look for gang tattoos and the classification officer reviews prior arrest history for gang affiliation.

**Gang Population Trend:** The following statements are from a memo from the Placer County Sheriff's Office Intelligence Unit.

"Since the Placer County Sheriff's Office began receiving AB 109 inmates, there was an immediate and noticeable difference with the gang culture within the jail. Since the Placer County Sheriff Correctional gang unit was re-established in 2012, hundreds of inmates have been validated as criminal street gang members. Inmate on inmate assaults has increased and through the investigation process, many are determined to be caused by gang members."

"In a jail setting, custody staff along with the Classification unit tries to facilitate housing of these rival gangs. Unfortunately with the current bed space available at both the Auburn Jail and South Placer Jail, Sureno inmates typically will have to be placed in single cells, away from general population to ensure their safety. This is due to the relative low number of Sureno's that are housed in the jail versus the number of Norteno inmates. However, this solution should not be looked at as a solution to the problems of rival gangs housed in a facility."

**Behavioral Crimes:** The category of Behavioral Crimes includes the following subcategories:

- Weapon Regulation Laws
- Prostitution
- Drug Laws
- Gambling
- Crimes Against Family
- DUI
- Liquor Laws
- Disorderly Conduct
- All Other Offenses (except Traffic Offenses)
- Juvenile Curfew Violations
- Runaway Juveniles
- Traffic Crimes (Serious Offenses)
- Fish and Game/Marine Violation

**Table C.1**  
**Placer County Crimes Reported from 2004 – 2014**

Crime Report Placer County											
Year	2004	2005	2006	2007	2008	2009	2010	2011	2012	2013	2014
<b>Violent Crimes</b>	150	127	234	255	296	315	298	301	278	262	289
Murder											
Manslaughter	1	5	2	2	3	4	0	4	0	1	0
Rape	10	17	28	26	21	27	24	25	24	28	26
Robbery	17	8	24	28	34	26	30	28	27	13	26
Aggravated Assault	122	97	180	199	238	258	244	244	227	220	237
<b>Crimes</b>	2,145	2,171	2,040	1,997	1,939	1,951	1,950	1,946	1,670	1,763	1,600
Burglary	734	789	684	634	691	660	645	622	568	640	514
Larceny	1,320	1,325	1,321	1,329	1,209	1,258	1,275	1,293	1,069	1,083	1,049
Vehicle Theft	91	57	35	34	39	33	30	31	33	40	37
<b>Total Report</b>	2,295	2,298	2,274	2,252	2,235	2,266	2,248	2,247	1,948	2,025	1,889

Source: State of California DOJ, CJSC Crimes Report



### C3 Annual Arrest Statistics

**Placer County Sheriff's Office Arrest Charges:** The following criminal justice statistics are from the California Department of Justice for Placer County Sheriff's Office. Of the 3,290 arrests in 2014, the top 7 charges in Placer County are represented in the table below.

**Table C.3  
Placer County Arrests 2014**

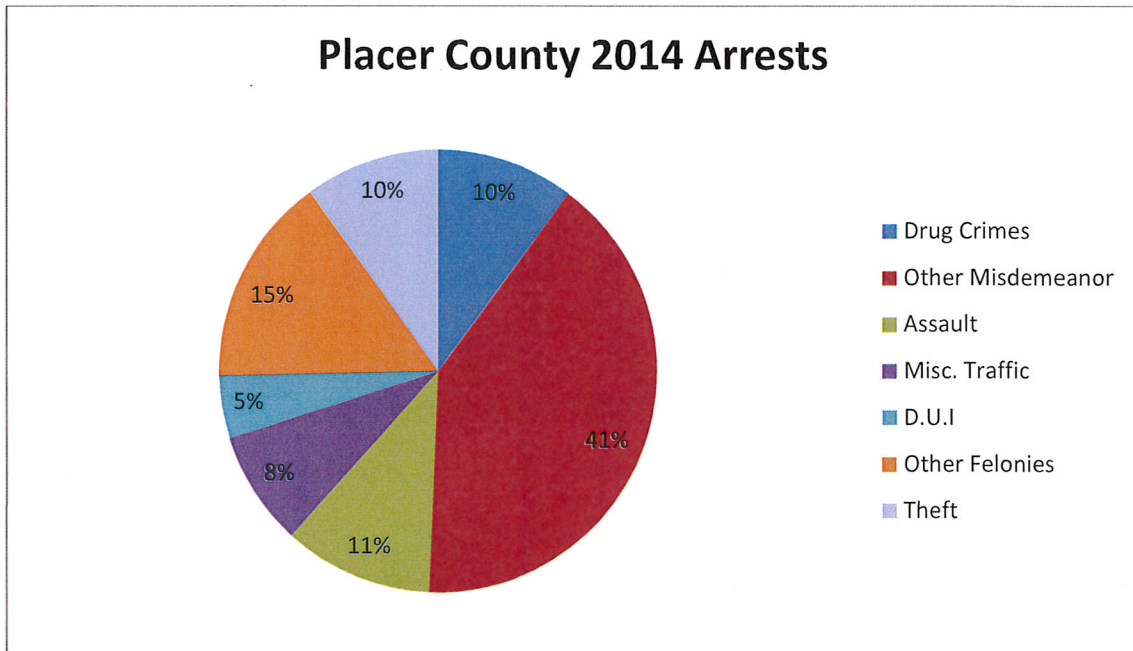

3. The duty sergeant will utilize the decision tree to house inmates after reviewing the inmate's booking file, criminal history, pre-classification screening and any other available information. All inmates will be initially housed according to the results of the decision tree.
4. Classification personnel will obtain CII and FBI criminal history records, booking file information, pre-classification screening, prior custody records and decision trees on all inmates. Classification will use this information to create an active inmate classification file.
5. Classification personnel will conduct assessment interviews with all inmates who will be housed after arraignment to determine the appropriate housing assignment.
6. Classification personnel will prepare an inmate movement list for floor officers to complete the inmate classification housing assignments.
7. Classification personnel will maintain active classification files on all inmates in custody.
8. Classification personnel will conduct periodic reclassification reviews on selected inmates.
9. Classification personnel will review inmate disciplinary hearing reports and make appropriate housing assignment changes.
10. Classification personnel will make inmate assignments to the minimum-security barracks.
11. Classification personnel will provide staff members with statistical data, information regarding inmates who pose a threat to the safety and security of the facility and legal update issues.

### D.3 Elements of the Classification System

Persons committed on criminal process and detained for trial may be kept or put in the same room with person convicted and under sentence for the purpose of participation in supervised activities and for purpose of housing, provided that the housing occurs as the result of a classification procedure. The procedure is based upon consideration of criminal sophistication, seriousness of crime charged, presence or absence of assaultive behavior, age and other criteria that will provide for the safety of prisoners and staff. Accordingly, the mandates outlined in these two regulations frame the structure of the classification system that must be followed for the proper classification of inmates. The criteria is as follows.

- Criminal Sophistication - Criminal history, prior incarceration history, size, demeanor, gang affiliation and prison tattoos are some factors that may tend to reveal a person's level of sophistication or lack thereof.
- Current Charges - Violence, property crimes, weapons used, and the circumstances surrounding the charges all may provide insight into a person's housing or program eligibility.
- Assaultive / Non-Assaultive Behavior - Acts committed during the commission of the current crime charged, during past or current arrest, past convictions, or prior custody may reveal a person's propensity for predatory violence.
- Age of the Inmate - Is the inmate of old or tender age?
- Sex of the Inmate - Determines gender specific housing.

Custody level refers to the inmate's potential to cause harm to staff members, other inmates and the community. The custody levels, along with any special housing concerns, are intended to separate the violent predatory inmate from the less sophisticated inmates. A high custody level may require closer supervision, more frequent checks, and staff to move the inmate along with prohibition from certain programs and activities.

**CUSTODY LEVELS**

- Minimum:** No need for special housing  
No pattern of assaultive convictions  
No Sex Convictions  
No parole or federal holds  
No prior escape history
- Minimum High:** Sentenced on at least 1 charge  
No Gang History  
No pattern of Discipline History
- Medium Low:** Not an escape risk  
Not a custody behavior problem  
Not Criminally Sophisticated/No Prison History
- Medium:** Not an escape risk  
Minimally sophisticated/Less than 4 years State Prison Level 1 or 2  
Not a custody behavior problem  
Waiting for transfer to M/S
- Maximum Low:** Criminally sophisticated/4+ years State Prison Level 3  
Current assaultive charges  
Escape History  
Custody behavior problem  
Prior assaultive convictions
- Maximum:** Criminally sophisticated/4+ years State Prison Level 3 and-Level 4 downgrades  
Current assaultive charges  
Past assaultive convictions  
Escape History  
Custody behavior problem  
Three or more violent felony convictions
- Maximum High:** 2 Officer Moves  
Criminally sophisticated  
Current Assaultive charges  
Past assaultive charges  
Custody behavior problems  
Escape history  
High profile 187 Case

Circumstances that may suggest a downward override include:

- Physical and/or medical conditions that make the inmate a lower threat.
- Absence of or no prior criminal history.
- Reliable patterns of behavior that suggest an inmate's willingness to conform to rule and benefit from institutional programs (work or education).

An inmate's housing may be temporarily changed for the purpose of protecting the inmate, protecting other inmates or staff members, pending disciplinary review of a safety violation, or preventing an escape. All temporary moves must be documented and the Classification unit notified. Permanent inmate housing assignments may only be determined by a trained Classification Officer, the Jail Commander and/or his designee.

### **Reclassification**

Once an inmate is classified, he or she may require reclassification depending on the changes in their charges, sentencing, medical and behavior status. Additionally, inmates who are administratively segregated for prolonged periods require monitoring of their isolation status. Reclassification may include reviewing the inmate's new status or conducting a follow-up interview of the inmate. The purpose of the reclassification is to determine a change of custody or security levels, eligibility or restriction of programs, or transfers. The following are examples of events that may suggest reclassification:

- Addition of new charges (Rebooking)
- Sentencing
- Prison commitments
- Medical or psychiatric treatment
- Documented behavior problems or model inmate behavior
- Prolonged administrative segregation status.

### **Federal Consent Decree**

In 1992, the Placer County Jail was placed under a Federal Consent Decree due to overcrowding. The Federal Consent Decree in essence stated the following:

The daily inmate population of the Placer County Jail will be regulated to operate at 90% of the established inmate population capacity. This figure now is 648 inmates. Currently 90% of our inmate population is 583.

When the inmate population reaches 90% of capacity, inmates may be released. When the inmate population exceeds capacity, inmates shall be released. No housing area shall exceed 100% of its rated capacity.



thinking/ behaviors that contribute to the cycle of repeated incarcerations. Some level of funding continues to be available for qualified inmates transitioning into the community.

**The Eternity Challenge**, a local faith based organization of volunteers under the umbrella of the Placer County Jail Chaplaincy. The Eternity Challenge offers limited in-custody group instruction on topics such as moral based behaviors and decision making, job interviewing and finances. In addition to the in-custody programming, the Eternity Challenge offers some limited transitional housing and vocational skill training and jobs to ex-offenders. The Eternity Challenge uses the Jericho Project's drug treatment protocol in their transitional housing.

The Sheriff's Corrections Division has long standing relationship and MOU with the "Placer School for Adults", Placer Union High School District. The adult school has provided basic adult education in the Auburn Jail for more than 20 years. Prior to the opening of the South Placer facility, jail staff worked with adult school teachers and administration to complete the newest and current curriculum for both Jails.

Available to some classifications of housed inmates through the adult school are the following programs:

- GED prep
- A/B English
- A/B Math
- A/B Literature
- Culinary
- Computer skills
- (Until recently life skills/employability)

Academic Brush (A/B) curriculum is for inmates that already possess basic adult education diploma/equivalency and are seeking further education in a particular subject or to use class time for additional GED test preparation.

### **LITERACY PROGRAM**

With inmate sentences stretching into years, it became painfully obvious to staff that much of the inmate population reads at or below the 5<sup>th</sup> grade level with many hovering around 3<sup>rd</sup> grade. This phenomenon has multiple effects on the Corrections education considering the limited resources and the Division's attempt to provide programming to the largest number of inmates. Working with the **Placer County Library System**, volunteer literacy tutors test, evaluate and assess the reading and writing skills of any inmate on request of staff. The Placer Library has weekly access to inmates at both jails. These tutors work individually with inmates on reading skills to raise the literacy level. GED prep classes are possible. For those inmates possessing a High School Diploma or GED and also reading below the 5<sup>th</sup> grade level, the jail encourages literacy tutoring for them as well.

### **NA / AA PROGRAM**

The Auburn and South Placer Jails have active **Narcotics Anonymous** and **Alcoholics Anonymous** programs.

**DRIVERS LICENCE LOSS/ CHILD SUPPORT SERVICES PROGRAM**

Many times incarcerated offenders are in arrears with child support payments. When this happens it is common for offenders to lose their driver's license until the debt is brought current. Without a driver's license, it can become difficult to find employment. "Placer County Child Support Services" partnering with SCOE/Probation and the Sheriff's Office are working to set aside this practice while inmates are active and meaningfully participating in SCOE programming in and out of custody.

**52 WEEK BATTERER PROGRAM**

This program is set to begin within 60 days of being in-custody. Inmates may begin the program prior to leaving custody and continue at the PREP center at no charge. This class satisfies Placer court ordered program.

**RE-ENTRY PROGRAM (Current)****2014 Placer County Probation/Corrections Re-Entry (PREP) Program**

In 2014, the Placer County Probation Department opened a request for proposals (RFP) to initiate an Official County Re-Entry program, "Placer Re-Entry Program" (PREP). Probation teamed with a Sheriff's representative and CEO staffer during the RFP process and interviewing of applicants. The outcome of this highly successful collaboration resulted in the RFP being awarded to the "Sacramento County Office of Education" (SCOE).

**MDT PROGRAM**

The Placer County Sheriff's Office in meaningful collaboration with the Placer County Probation Department, Placer County Health and Human Services, Placer Union High School District (Placer School for Adults) and the Sacramento County Office of Education are the key players comprising an efficient functionally active weekly "Multi-Disciplinary Transition Team" (MDT).

**Placer County Re-Entry (PREP) in Practice, PROGRAM (Two phases)**

Currently, the requirements for; in-custody PREP placement, CAIS assessment med/med-high/high risk for re-offending, Placer County mandatory supervision and Probationers places Placer County residents at risk for re-offending particularly for out of county mandatory supervision and out of county residence. At this time the number of male inmates in PREP is 15 with a waiting list. Female MS PREP participants total 8 with a waiting list.

**PREP In-Custody PROGRAM (one month old)**

SCOE currently conducts daily in-custody programming for both male and female Minimum Security inmates. Initially inmates are selected for PREP by Probation, SCOE Transitional Specialists and Corrections via CAIS assessments and other criteria. South Placer MS inmates currently program three hours/ day with Transitional Specialist; topics include Parenting, Anger Management and Health.

Implementation of the in-custody PREP programming includes increased meaningful and productive contact with Probation officers while inmates are programming in custody. Transition Specialist work with inmates, Probation Officers and Custody on exit planning/strategies and other re-entry topics. MDT members pool resources for creative solutions to re-entry issues.

The MDT meet weekly on agenzized topics including the status of individuals moving through PREP program, recent assessments, applications or recommendations for supervising Probation Officers/jail staff.

### E3 Placer County Probation Department

The Probation Department is designated as the county agency responsible for implementing Post Release Community Supervision as specified in Section 3451 of the California Penal Code and will provide the following related services:

- Referrals to Treatment, Educational, and Vocational Services
- Arrest and Flash Incarceration
- Imposition of sanctions that are consistent with evidence based practices
- Facilitate Collaborative Operations with Local Law Enforcement Agencies
- In partnership, participate in Mental Health Court
- Collaboration with CDCR on Returnees
- Continue to conduct OR and Pretrial Assessments on offenders detained in the jail
- Respond to offender's inquiries regarding probation services and Alternative Sentencing Programs
- Continue to supervise and operate the Electronic Monitoring and Adult Work Release programs
- Supervise and operate the Pretrial Supervision Program
- Measure Activities and Program Outcomes

### E4 Probation Alternative to Incarceration Programs

Currently, the probation department manages the Electronic Monitoring Program [EMP], Work Release (WR), Adult Drug Court and Pre-trial EMP. The Probation chief believes that they are largely successful as long as they have the ability to balance them with sanctions. This requires bed space in the jail to hold violators accountable. He further believes that the programs need to have a seamless transition from in-custody to probation supervision and eventual unsupervised release into the community. These programs have helped reduce the number of early releases by the jail and have increased the number of beds available to hold more serious offenders accountable.

The Probation Department partners with Health and Human Services (HHS) in some programs. A probation officer sits on a Mental Health advisory board and is a liaison for the transitional services provided by HHS to offenders. This helps to have continuity for the offender as they move through the system.

The following charts depict the Probation Department's adult Alternatives to Incarceration [ATI] programs:

1. Electronic Monitoring Program [EMP] for sentenced offenders
2. Adult Work Release (AWR) for sentenced offenders
3. Pre-Sentenced Electronic Monitoring Program (Pre-EMP)
4. Supervised Own Recognizance (Sup. OR)

The total number of program participants has increased over the last 5 years and has allowed a reduction in early releases [via Federal consent decree] by the jail staff with the benefit of holding more serious offenders accountable.



## F1 County Population Projections

**Table F.1**  
Placer County Historical and Projected Population 1970 - 2050

<b>Placer County Historical Population</b>			
<b>Calendar Year</b>	<b>Population</b>	<b>Percentage Increase</b>	<b>Averages Per Decade</b>
<b>1970</b>	77,632	0	0
<b>1980</b>	120,700	55%	55%
<b>1990</b>	170,100	41%	48%
<b>2000</b>	248,399	46%	47%
<b>2010</b>	348,432	40%	46%
<b>2020</b>	396,203	14%	39%
<b>2030</b>	447,625	13%	35%
<b>2040</b>	509,936	14%	32%
<b>2050</b>	566,954	11%	26%

Historical population conclusions:

- Placer County is rated second among all California Counties in the rate of population growth from 2003 to 2013 based on the California Department of Finance data.
- According to the California Department of Finance population projections, Placer County population is projected to grow at a steady rate of about 1.3% per year or 12% to 14% per decade.

**Table F.2**  
Projected Placer County Population 2010 – 2040

<b>Placer County Population Projections</b>		
<b>Calendar Year</b>	<b>County Population</b>	<b>Percentage Increase</b>
<b>2010</b>	350,230	0
<b>2015</b>	373,503	7%
<b>2020</b>	396,203	6%
<b>2025</b>	421,002	6%
<b>2030</b>	447,625	6%
<b>2035</b>	478,196	7%
<b>2040</b>	509,936	7%
<b>2045</b>	539,147	6%

Population projections conclusions:

- Projected populations indicate an increase in historical growth by about 6% to 7% per five year period.

**Table F5:**  
**Total Bookings by Classification**

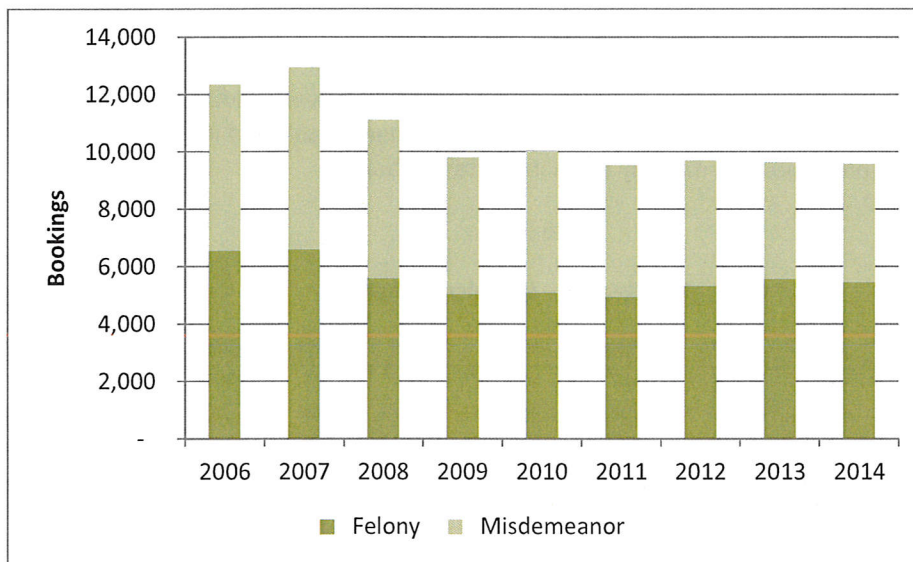

**B. Average Daily Population trends**

The County of Placer collected monthly data for the last nine years, for what is considered “in-county” population housed at any of the County’s detention facilities. The data includes the AB109 population. The data is presented in the Table below.

**Table F6:**  
**Monthly Average Daily Population**

ADP	2006	2007	2008	2009	2010	2011	2012	2013	2014	2015
January	583	605	574	537	558	507	553	615	652	620
February	576	604	576	480	558	519	558	626	660	618
March	580	609	579	532	561	493	589	639	654	602
April	586	598	575	539	553	519	611	632	650	617
May	589	594	591	561	553	529	595	618	645	617
June	589	598	584	562	536	535	606	619	661	
July	594	590	584	543	528	530	613	617	695	
August	596	594	597	543	557	534	617	632	705	
September	598	592	598	559	561	545	595	642	697	
October	602	583	565	558	534	534	594	643	663	
November	590	586	543	560	518	533	600	642	636	
December	581	576	541	535	487	544	606	641	611	
Average:	589	594	576	542	542	527	595	631	661	615
Avg 3-mo High:	599	606	595	561	560	541	614	642	699	618
Peaking Factor:	1.7%	2.0%	3.4%	3.4%	3.3%	2.8%	3.2%	1.9%	5.8%	0.6%

**Table F9:**

**Monthly Releases – Early Releases**

Releases: Early	2006	2007	2008	2009	2010	2011	2012	2013	2014	2015
January	143	177	209	84	30	9	29	24	69	14
February	132	158	118	25	22	8	9	17	58	3
March	149	223	208	31	29	14	4	55	49	3
April	123	144	165	31	14	5	8	94	45	5
May	150	171	181	65	20	16	11	62	84	
June	144	212	189	74	15	17	31	66	42	
July	178	168	188	49	19	5	28	48	33	
August	148	209	162	44	12	4	25	35	54	
September	191	185	135	43	6	18	13	66	38	
October	145	164	79	54	2	1	29	64	25	
November	156	170	66	72	7	8	10	65	19	
December	83	150	67	38	1	26	8	48	8	
<b>Monthly Average</b>	<b>145</b>	<b>178</b>	<b>147</b>	<b>51</b>	<b>15</b>	<b>11</b>	<b>17</b>	<b>54</b>	<b>44</b>	<b>6</b>
<b>Annual Total</b>	<b>1,742</b>	<b>2,131</b>	<b>1,767</b>	<b>610</b>	<b>177</b>	<b>131</b>	<b>205</b>	<b>644</b>	<b>524</b>	<b>75</b>

**Table F10:**

**Monthly Releases – Federal Cap Early Releases**

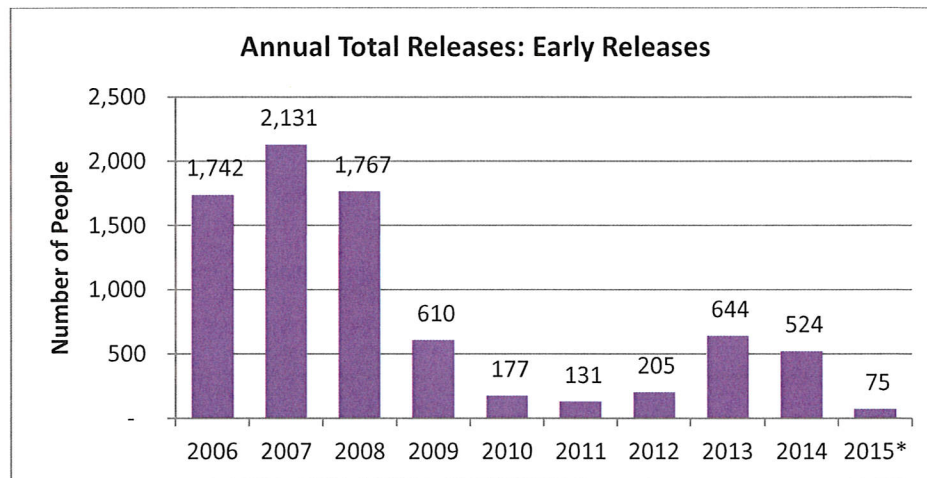

These totals Federal Cap Releases help keep the ADP down. If factored back into the system, one could assess what would be the true ADP. In order to calculate the potential impact these releases might have on the system, an estimated average length of stay is applied to the totals to calculate the potential ADP.

### E. Projected Average Daily Population (ADP)

The base ADP is likely artificially low because of the Federal Cap mandate and the large amount of releases the County has been doing. A set of projections were developed using the base monthly ADP that the County sends to the BSCC on a regular basis. This scenario assumes that the releasing process will continue to maintain the cap. A second set of projections were developed using an adjusted ADP, where the releases were incorporated back into the ADP, under the assumption that the County would not have to release individuals for lack of space.

The monthly release data was translated into ADP using the estimated average length of stay computed and presented in Table 5. The Table below presents the results.

**Table F13:**

#### Adjusted Average Daily Population

<b>ADJUSTED ADP w/ RELEASES</b>	<b>2006</b>	<b>2007</b>	<b>2008</b>	<b>2009</b>	<b>2010</b>	<b>2011</b>	<b>2012</b>	<b>2013</b>	<b>2014</b>
<b>In-County w/ AB109 Base ADP</b>	589	594	576	542	542	527	595	631	661
<b>Fed Cap PTA Releases</b>	1,376	1,738	2,300	1,299	464	281	506	1,689	2,317
<i>ADP Impact<sup>1</sup></i>	75	89	128	77	27	17	32	114	165
<b>Fed Cap Early Releases</b>	1,742	2,131	1,767	610	177	131	205	644	524
<i>ADP Impact<sup>1</sup></i>	94	110	98	36	10	8	13	44	37
<b>Total In-County ADP with Impact of Releases</b>	758	793	802	656	579	551	640	788	863

<sup>1</sup> Calculated by applying the corresponding In-County ALOS for the year.

The base ADP had seemed to follow a slight downward trend between 2006 and 2011 and the number of releases declined accordingly after 2008. After 2011, the ADP has increased steadily as a result of AB109 and the influx of new felons. The BSCC estimated that at full implementation, the impact to Placer County would be estimated ADP of 276. As Table 7 shows, the ADP numbers for AB109 are very close, estimated at 227 in 2012, 248 and 253 in 2013 and 2014 respectively. The impact of these numbers has likely caused a spike in the number of releases. In 2014, had there been no releases, the ADP could potentially have reached 863.

**G. Recommendations:**

Using the Average Daily Populations projections between the years 2016 and 2020 and adding to these projections for peaking and classifications we arrive at the following recommendations. The following chart indicates three sets of numbers

1. Projected ADP utilizing the "Status Quo" mathematical and population based.
2. Projected ADP "Including Releases" mathematical and population based.
3. Projected Rated Bed Capacity of proposed facility.

**Table F16:**

**Summary of ADP including Peaking and Classification factors for the Jail System.**

<b>SB 863 Inmate ADP / RBC Projection Summary</b>						
	Year					
	2016	2019		2020		
Projected ADP or RBC	Base	Peaking & Classification	Base	Peaking & Classification	Base	Peaking & Classification
<b>Status Quo: ADP with current releases</b>						
Model: Historical (ARIMA)	620	732	626	739	628	741
Model: Ratio to resident population	689	<b>813</b>	714	<b>842</b>	722	852
<b>Historical Adjusted: ADP including releases</b>						
Model: Historical (ARIMA)	822	970	857	1012	869	1025
Model: Ratio to resident population	834	<b>984</b>	864	<b>1020</b>	874	1031

**Conclusion:** With the closure of the two outdated housing units at the Auburn Jail and constructing new custody specific replacement housing (Re-Entry and Mental Health) at South Placer Jail, the County Jail system will have a new RBC of 784. This RBC falls in the middle range of the projected ADP of Historical operations and ratio to population therefore providing a proper and focused bed replacement program.

**The Corrections Division staff consists of the following:**

Corrections Commander (Captain)	Jail Intelligence Deputy
Corrections Lieutenant	Programs Officer
Corrections Secretary	Corrections Support Program Manager
Administrative Sergeant	Administrative Legal Supervisor
Operations Sergeant	Senior Administrative Legal Clerk
Floor Sergeant	Administrative Legal Clerk
Shift Sergeant	Inmate Services Account Clerk
Transportation Sergeant	Account Clerk
Minimum Security Sergeant	Court Liaison Officer
Corrections Officer	Court Security Lieutenant
Corrections Canine Officer	Court Security Sergeant
Facilities Services Officer	Court Bailiff
Utility Officer	Deputy Sheriff
Classification Officer	Assistant Deputy Sheriff
Corrections Compliance Officer	Transportation Officer

**Jail Policy:** The Placer County Sheriff Corrections Division maintains the constitutional, secure and humane detention of all arrested person as prescribed by law.

**G2 Staffing Levels:**

**Staff Issues:** Detention facilities must be staffed 24 hours a day, seven days a week in order to fulfill their mandate to provide safe and secure housing for those inmates under their care. Staff within the Placer County Jail System must be available to receive new bookings in the jail, provide for medical care, classify and move inmates within the facility, maintain staff and inmate safety and security, provide recreation and exercise, ensure inmates are fed, transport inmates to court or outside agencies and lawfully release inmates. Due to its nature, a jail cannot simply discontinue operation (e.g., refuse to accept prisoners) if there is not a person available to fill a position. When detention facilities are not staffed adequately, overtime is necessary to cover an unfilled post.

**Shift Schedule:** Placer County utilizes a very common and efficient 12-hour, two shift a day schedule. Officers work six 12-hour days and one 8- hour day every two weeks. Hours are 7:00 AM to 7:00 PM and 7:00 PM to 7:00 AM. All correctional personnel are on this schedule with the exception of specialized staff such as classification and programs. Training is provided using overtime on officer's days off.

**Fixed Post Staffing Requirements:** A jail is a 24 hour a day, 365 days a year operation that requires minimum staffing levels. Depending on many factors, including time off for vacations, sick leave, injuries and training, as well as the type of schedule, the number of officers required to staff the facility can vary.

A fixed post is a position in the jail which must be staffed 24 hours per day, 7 days per week, 365 days per year. The types of staffing plans require a different number of officers to staff the position 24-7-365. Eight and twelve hour schedules require fewer officers to staff a fixed post than a nine or ten hour schedule. Fortunately, Placer County utilizes the very efficient 12-hour plan to allow the most efficient way of using the allocated personnel. Using the National Institute of Corrections (NIC) method, generally 5.1 to 5.3 officers are required to staff a fixed post on a twelve plan.

### G3 Staffing Issues:

#### Staffing issues facing the Placer County Jail include:

Minimum staffing is the level of staff required to operate a detention facility in a manner that will provide basic safety and security for the public, staff and inmates. Minimum staffing levels establish a baseline by which detention facilities may operate, yet minimum staffing is precariously low. The county is exposed to potential liability because this implies that basic safety and security are no longer protected. Minimum staffing levels are influenced and affected by various factors including facility design and inmate profile/classification level and County budget constraints.

- A. Vacancies, extended periods of leave, and normal staff attrition underscore the importance of maintaining a minimum number of staff. Staff at the Placer County Jail is leaving for employment at other law enforcement agencies that offers either higher pay and or enhanced benefits. With vacant positions, the jail has an increased reliance on overtime to meet minimum staffing
- B. Detention facilities often utilize overtime to cover an unfilled post. There is no way for detention facilities to eliminate all use of overtime; it is a necessary component of staffing a 24-hour a day, seven days a week operation. However, to save the County money and remove the potential for staff burnout, efforts should be made to reduce the number of overtime hours.
- C. Chronic understaffing causes a host of other issues detrimental to the mission of the jail. It lowers morale, employees are unable to take breaks, employees get "burned out" with mandatory overtime, employees must take "shortcuts" to get the job done and employees are forced to assume collateral duties to allow the facility to function.
- D. Placer County should continue to aggressively recruit and fill all vacant positions. They should also continue to "over hire" above the authorized staffing to fill in when a vacancy occurs. Some counties refer to this as "pipeline" hiring. There are always people in the "system" or pipeline from background processing to attending the academy.

While the above difficulties are common in most County Jail systems, the lack of adequate program support spaces and offices exacerbate Placer County difficulties. Thus, the "need" for a Special Needs detention housing facility expansion goes well beyond a simple "need" for replacement beds. The additional "need" is for a facility that protects the safety of correctional officers (by providing adequate beds of the correct type for Special Needs Inmates) and provides staff with a professional environment in which to work.

## H2 New Facilities Design

Design Goals for any New Detention Beds and Support Space added to the South Placer Jail Facility should be as follows:

- Be a state-of-the-art, new generation, direct visual supervision, podular, adult detention facility that meets the requirements of BSCC and American Corrections Association.
- Provide a safe and secure environment for staff, visitors, volunteers and adults with a well defined secure perimeter that includes secure pedestrian inmate and staff access to the existing facility.
- Consist of housing units with the flexibility to meet a wide variety of varying special needs classification needs (e.g., mental health housing of various levels of care, female housing, special needs housing of varying levels of care, etc.).
- Provide spaces for a wide variety of programs and vocational training to reduce recidivism and thus reduce County, State and Federal criminal justice system long term costs.
- Provide a professional work environment and adequate space for custody staff, teachers, medical and mental health professionals, other professionals providing program services and volunteers.
- Be cost efficient to build and operate.
- Be energy efficient and environmentally friendly to reduce operating costs.
- Be staff efficient to preserve County resources.
- Meet the requirements of the Americans with Disabilities Act (ADA).
- Meet the requirements of the Prison Rape Elimination Act (PREA).
- Provide adequate, easily supervised adult exercise and recreation spaces to reduce tension and contribute to the success of programs, especially the special needs mental health programs.
- Include additional new food service equipment as necessary for the additional bed capacity to ensure that meals meet the nutritional requirements determined by the county and to provide vocational education program opportunities.
- Provide additional new laundry equipment to provide clean inmate clothing, bedding and associated items related to the additional beds.
- Provide secure spaces within the new housing units for restricted contact, non-contact and video visiting. Provide additional public video visitation equipment for the added bed capacity visitation needs.



### **I 3 Required records maintained by Placer County Corrections Division include:**

- Fiscal records.
- Booking/arrest records
- Admittance records
- Intake screening records
- Initial classification assessments
- Records of classification reviews
- Release procedures
- Incident reports
- Records of assaults that involve inmates
- Disciplinary records
- Grievances
- Population accounting ("head counts")
- Counseling and casework services plan
- Health care records (including mental health and dental)
- Psychotropic medication logs
- Employee files containing health care staff credentials (for the contract service provider)<sup>1</sup>
- Commissary records and inmate commissary account records
- Fire inspections
- Health inspections
- Environmental health inspections
- Building inspections
- Inmate cash accounting
- Food service plan
- Diet menus (including therapeutic diets when ordered).
- Food preparation temperature logs (to verify food is served at the correct temperature)
- Emergency procedures
- Evacuation plans
- Room check logs (safety checks)
- Employee files and personnel records
- Staff training records
- Staff assignments (current and historic) and staffing plans
- Reports of legal actions
- Annual security review
- Transportation logs





**L3 Rated Bed Capacity Recommendation:**

The following tables indicate the recommended Rated Bed Capacity (RBC)

**Table L2  
Recommended Rated Bed Capacity for Placer County Jail**

Auburn Jail Housing Unit		Current 6/10/2015	Current Utilization	After SB863
1	A Tank	4	Administrative Segregation (males)	
1	B Tank	8	Disciplinary Isolation (males)	
1	C Tank	8	Administrative Segregation (males)	
2	D Tank	20	Administrative Segregation (males)	20
2	E Tank	20	Administrative Segregation (males)	20
2	F Tank	20	Mental Health Issues (male)	20
2	G Tank	20	Maximum - Low w/ issues (female)	20
3	H Tank	54	Medium (males)	
3	I Tank	52	Medium - Low New Intakes (males)	
3	J Tank	32	Medium - High (females)	
3	K Tank	32	Medium - Low No Prison Time (females)	
3	L Tank	52	Medium - Low No Prison Time (males)	
3	M tank	54	Medium - High AB109 (males)	
4	N Tank	16	Administrative Segregation, 2 Officers (males)	16
4	O Tank	32	Max - Low No Prison Time (males)	32
4	P Tank	32	Max - High w/Prison History (males)	32
4	R Tank	16	Administrative Segregation, 2 Officers (males)	16
	MS4	20	Minimum Security Cadre (males)	20
		<b>492</b>		<b>196</b>

Auburn County Jails current RBC of 492 with a reduction of 296 beds will provide 196 beds remaining at Placer County Jail.

**L4 Building Additions, Renovations and Improvements Recommendations:**

The proposed South Placer County Jail facility recommendations are comprised of seven Building additions and Improvements as follows:

1. Program Services building additions
  2. Education and Vocational Training building additions
  3. Female Minimum Security Housing additions
  4. Re Entry Housing additions
  5. Mental Health, Special Needs Housing additions
  6. Kitchen and Laundry Equipment improvements
  7. Site Infrastructure improvements
- 1) Programs services additions will be developed in the secure areas of the jail. Programs in secure areas will serve the existing housing units and new housing units for mental health. This space will include a multi-purpose media room, library / law library, office / workroom, conference room and support space for program staff.
  - 2) Education and Vocational training addition will be developed outside and inside the secure perimeter of the Jail. Outside facilities can capitalize on outside resources for vocations and education services volunteers and opportunities while assisting in security to help reduce the introduction of contraband into the secure Jail. Outside jail security facilities will consist of two education classrooms and two vocational shops with support spaces. Inside jail security facilities will consist of two educational classrooms and support spaces.
  - 3) The Female Minimum security housing unit addition will provide 60 beds divided into 5 person mini dorms and dayroom. Each pod will have support space, toilets and showers and general support space associated with the living units. This unit will be located outside the jail perimeter security to facilitate it function with the inmate population.
  - 4) The Re-Entry Housing unit will be comprised of a minimum housing unit with three 5 person mini dorms and dayroom. Each pod will have support space, offices, toilet shower areas and general support associated with the living units. This unit will be located outside the jail perimeter security to facilitate it function with the inmate population.
  - 5) The Mental Health Housing Unit addition is comprised of adding a housing unit with two 24 bed mental health housing pods, associated dayroom, support space, outdoor recreation, mental health offices and general support associated with the living units. The unit will be located attached to the existing facility such that medical services are in close proximity.
  - 6) Food Service scope includes addition of equipment to accommodate additional bed capacity. Laundry services scope includes additional equipment to accommodate the additional bed capacity.
  - 7) Site infrastructure upgrades are needed for site work, utilities, parking and landscaping to accommodate the above additions and improvements.